

# SEC-Boring Bars S-CTFP Type

## General Boring (Top Clamp Type)

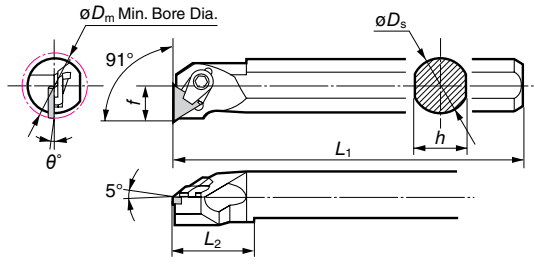
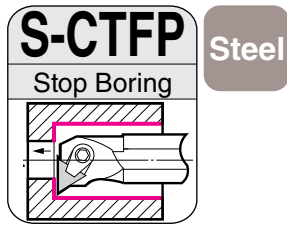

■ Holder Right handed toolholders are applicable with left handed or neutral inserts.  
Left handed toolholders are applicable with right handed or neutral inserts.

Above figures show right hand tools.

### ■ Spare Parts

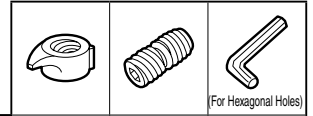

Shank	Cat. No.	Conventional Cat. No.	Stock		Dimensions (mm)							Applicable Insert	Clamp	Double Screw	Wrench
			R	L	$\phi D_m$	$\phi D_s$	$h$	$L_1$	$f$	$L_2$	$\theta^\circ$				
Steel	S12M-CTFP R/L1103-16	S12M-CTFP R/L11	●	●	16	12	11	150	8.0	17	-6	TP □□ 1103□□	CCM5BSL/R (R: Made to order)	WB5-10	LH025
	S16Q-CTFP R/L1103-20	S16Q-CTFP R/L11	●	●	20	16	15	180	10.0	18	-4				
	S20R-CTFP R/L1103-25	S20R-CTFP R/L11	●	●	25	20	18	200	12.5	18	-2				
	S25S-CTFP R/L1603-32	S25S-CTFP R/L16	●	●	32	25	23	250	16.0	38	-2				

■ Insert ( Coated / Cermet / Carbide / SUMIBORON)

### ● 11° Relief G-Class

TPGR W	Stock						Dimensions (mm)		
	T1500Z	T1000A	T1500A	T110A	T1200A	ST10P	Inscribed circle	Thickness	Nose Radius
Cat. No.									
TPGR 110302R-W	●	●	●				6.35	3.18	0.2
110302L-W	●	●	●						0.4
110304R-W	●	●	●		▲				0.4
110304L-W	●	●	●	▲	▲	●			0.8
110308L-W	●	●	●		▲				0.8
TPGR 160302R-W	●	●	●				9.525	3.18	0.2
160302L-W	●	●	●						0.4
160304R-W	●	●	●		▲				0.4
160304L-W	●	●	●	▲	▲	●			0.8
160308R-W	●	●	●		▲				0.8
160308L-W	●	●	●		▲		0.8		

### ● 11° Relief G-Class

#### ● SUMIBORON

TPGN	Stock						Dimensions (mm)		
	BNX20	BN2000	BN250	BN500	BN7000	BN700	Inscribed circle	Thickness	Nose Radius
Cat. No.									
TPGN 110304	●	●	▲				6.35	3.18	0.4
110308	●	●	▲						0.8
TPGN 110304HS	—	—	—	—	—	—			0.4
110308HS	—	—	—	—	—	—	0.8		
TPGN 160304	●	●	▲	●	●	●	9.525	3.18	0.4
160308	●	●	▲	●	●	●			0.8
TPGN 160304HS	—	—	—	—	—	—			0.4
160308HS	—	—	—	—	—	—	0.8		

\* HS: for Strong Edge Type

TPGN	Stock							Dimensions (mm)				
	AC510U	T1000A	T1500A	ST20E	A30	G10E	H1	NB90S	NB100C	Inscribed circle	Thickness	Nose Radius
Cat. No.												
TPGN 110302	●	●	●				●			6.35	3.18	0.2
110304	●	●	●				●		0.4			
110308	●	●	●				●		0.8			
TPGN 160302	●	●	●				●		9.525	3.18	0.2	
160304	●	●	●				●				0.4	
160308	●	●	●				●				0.8	
160312	●	●	●				●				1.2	

### ● 11° Relief M-Class

● SUMIBORON One-use Type (●: 1pc. per package stock, ●: 1pc. per package and 10pc. per package stock)

NU-TPGN	Stock							Dimensions (mm)			
	BNX20	BN1000	BN2000	BN250	BN350	BN500	BN7000	BN700	Inscribed circle	Thickness	Nose Radius
Cat. No.											
NU-TPGN 110302	●	●	●						6.35	3.18	0.2
110304	●	●	▲	●	●	●	●				0.4
110308	●	●	▲	●	●	●	●				0.8
110302LT	—	—	—	—	—	—	—	—			0.2
110304LT	—	—	—	—	—	—	—	—			0.4
110308LT	—	—	—	—	—	—	—	—			0.8
110302LS	—	—	—	▲	—	—	—	—			0.2
110304LS	—	—	—	▲	—	—	—	—			0.4
110308LS	—	—	—	▲	—	—	—	—	0.8		
110304HS	—	—	—	—	—	—	—	—	0.4		
110308HS	—	—	—	—	—	—	—	—	0.8		
NU-TPGN 160302	●	●	●						9.525	3.18	0.2
160304	●	●	▲	●	●	●	●				0.4
160308	●	●	▲	●	●	●	●				0.8
160304LT	—	—	—	—	—	—	—	—			0.4
160308LT	—	—	—	—	—	—	—	—			0.8
160302LS	—	—	—	▲	—	—	—	—			0.2
160304LS	—	—	—	▲	—	—	—	—			0.4
160308LS	—	—	—	▲	—	—	—	—			0.8
160304HS	—	—	—	—	—	—	—	—	0.4		
160308HS	—	—	—	—	—	—	—	—	0.8		

\* LT: for fine boring of hardened steel LS: Continuous cutting HS: for Strong Edge Type