

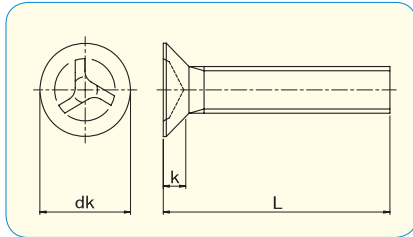

TRI-WING® FLAT HEAD MACHINE SCREWS



• **Material**
Stainless Steel A2



	M3	M4	M5	M6	M8
dk	5.5	8.4	9.3	11.3	15.8
k	1.65	2.7	2.7	3.3	4.65
Drive Size	W2	W4	W5	W6	W7



RoHS Directive Compliance

SIZE	PART #		Box q'ty
	d	L	
M3	6	TW020306	100
	8	TW020308	100
	10	TW020310	100
	12	TW020312	100
	16	TW020316	100
	20	TW020320	100
M4	25	TW020325	100
	6	TW020406	100
	8	TW020408	100
	10	TW020410	100
	12	TW020412	100
	16	TW020416	100
M5	20	TW020420	100
	25	TW020425	100
	30	TW020430	100
	10	TW020510	100
	12	TW020512	100
	16	TW020516	100
M6	20	TW020520	100
	25	TW020525	100
	30	TW020530	100
	40	TW020540	100

SIZE	PART #		Box q'ty
	d	L	
M6	10	TW020610	100
	12	TW020612	100
	16	TW020616	100
	20	TW020620	100
	25	TW020625	100
	30	TW020630	100
	40	TW020640	100
	50	TW020650	100
M8	16	TW020816	100
	20	TW020820	100
	25	TW020825	100
	30	TW020830	100
	40	TW020840	100
	50	TW020850	100

Please see page 40-41 for tools.

TRI-WING® is a registered trademark of Phillips screw Co.

- HE
- SP
- OW
- TX
- TW**
- SF
- SS
- PH
- TC
- TOOLS
- Order Made