

Linear Rail System

SBI High-load Linear Rail System

SBI-FL/FLS/FLL

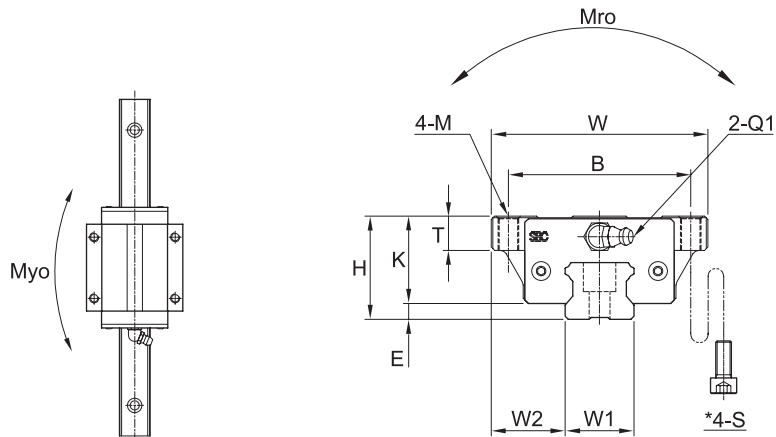

Model	Mounting dimension				Block dimensions													
	H	W	L	E	Mounting tap hole				L1	T±1	K	Grease fitting						
					B	J	M	*S				T1	N1	T2	N2	Q1	*Q2	
SBI15 FLS	24	47	56.8	3	38	30	M5	M4	38.2	11	21	4.5	5.5	3.8	3.8	M4x0.7	Ø3.5	
SBI15 FL	24	47	63.8	3	38	30	M5	M4	45.2	9	21	4.5	5.5	3.8	3.8	M4x0.7	Ø3.5	
SBI15 FLL	24	47	79.4	3	38	30	M5	M4	60.8	9	21	4.5	5.5	3.8	3.8	M4x0.7	Ø3.5	
SBI20 FL	30	63	78.8	4.6	53	40	M6	M5	56.8	12	25.4	6	12	5.8	5	M6x0.75	Ø3.5	
SBI20 FLL	30	63	96.4	4.6	53	40	M6	M5	74.4	12	25.4	6	12	5.8	5	M6x0.75	Ø3.5	
SBI25 FL	36	70	92	5.5	57	45	M8	M6	70	13	30.5	6	12	5	5	M6x0.75	Ø3.5	
SBI25 FLL	36	70	108	5.5	57	45	M8	M6	86	13	30.5	6	12	5	5	M6x0.75	Ø3.5	
SBI30 FL	42	90	107.6	7	72	52	M10	M8	79.6	15.5	35	8.5	12	7.8	5	M6x0.75	Ø5.7	
SBI30 FLL	42	90	131.6	7	72	52	M10	M8	103.6	15.5	35	8.5	12	7.8	5	M6x0.75	Ø5.7	
SBI35 FL	48	100	124.6	7.5	82	62	M10	M8	94.6	15	40.5	8	12	8	6	M6x0.75	Ø5.7	
SBI35 FLL	48	100	152.6	7.5	82	62	M10	M8	122.6	15	40.5	8	12	8	6	M6x0.75	Ø5.7	
SBI45 FL	60	120	142	9	100	80	M12	M10	108	18	51	10.5	13.5	9.3	6.5	PT1/8	Ø5.7	
SBI45 FLL	60	120	174	9	100	80	M12	M10	140	18	51	10.5	13.5	9.3	6.5	PT1/8	Ø5.7	
SBI55 FL	70	140	172.4	12	116	95	M14	M12	131	22	58	12	13	12	8	PT1/8	Ø8.7	
SBI55 FLL	70	140	211.8	12	116	95	M14	M12	170.4	22	58	12	13	12	8	PT1/8	Ø8.7	
SBI65 FL	90	170	219.8	19	142	110	M16	M14	170.4	26	71	14	13	14	10	PT1/8	Ø8.7	
SBI65 FLL	90	170	272.2	19	142	110	M16	M14	222.8	26	71	14	13	14	10	PT1/8	Ø8.7	

① C (Basic dynamic load rating), Co (Basic static load rating)

② *S: Bolt size for bottom mounting type of block.