

Outline View

SUS • BsBM • Cd-less BsBM

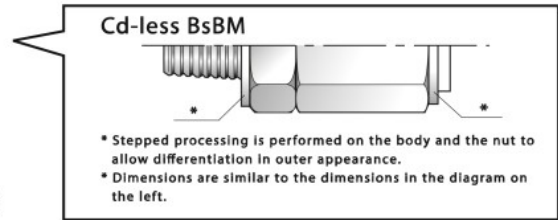
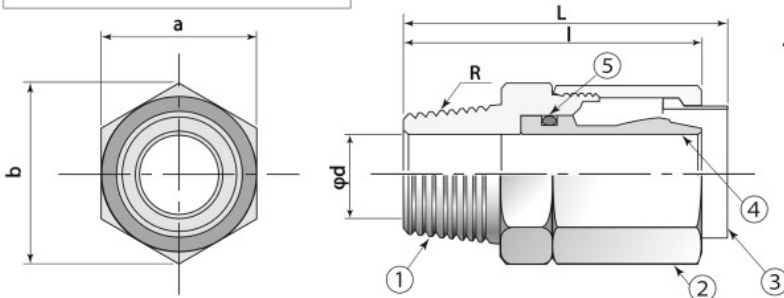

Unit: mm

Model	R	L	I	φd	Hose diameter Inner x outer	a	b	O-ring Nominal diameter	Model	R	L	I	φd	Hose diameter Inner x outer	a	b	O-ring Nominal diameter				
TH 4-1/8	1/8	34.8	32	4.0	φ4×9	17	19.6	P6	TH 15-1/4	1/4	47.7	43.8	8.0	φ15×22	30	34.6	P16				
TH 4-1/4	1/4	35.8	33	4.0					TH 15-3/8	3/8	49.7	45.8	10.0								
TH 6-1/4	1/4	45.3	41.5	5.0	φ6×11	21	24.3	P6	TH 15-1/2	1/2	51.7	47.8	14.0					φ19×26	35	40.5	P20
TH 6-3/8	3/8	47.3	43.5	5.0	φ8×13.5	22	25.4	P9	TH 15-3/4	3/4	53.7	49.8	14.0								
TH 8-1/4	1/4	44.7	40.8	7.0	φ9×15	24	27.7	P9	TH 19-1/2	1/2	59.8	54.3	14.0	φ21.5×29	38	43.9	P22				
TH 8-3/8	3/8	46.7	42.8	7.0					TH 19-3/4	3/4	63.8	58.3	17.4								
TH 9-1/4	1/4	46.4	42.4	7.0	φ10×16	24	27.7	P10	TH 19-1	1	64.8	59.3	17.4					φ25×33	42	48.5	P24
TH 9-3/8	3/8	48.4	44.4	7.0					TH 22-1/2	1/2	61.0	56.0	14.0								
TH 10-1/4	1/4	46.4	42.4	8.0	φ12×18	26	30.0	P11	TH 22-3/4	3/4	65.0	60.0	19.4	φ32×41	54	62.4	P32				
TH 10-3/8	3/8	48.4	44.4	8.0					TH 22-1	1	66.0	61.0	21.0								
TH 10-1/2	1/2	50.4	46.4	8.0	TH 25-3/4	3/4	65.8	60.8	18.0	φ32-1 1/4	74.3	69.0	28.0								
TH 12-1/4	1/4	46.3	42.4	8.0	TH 25-1	1	67.8	62.8	24.0												
TH 12-3/8	3/8	48.3	44.4	10.0	TH 32-1 1/2	1 1/2	75.3	70.0	28.0												
TH 12-1/2	1/2	50.3	46.4	10.0																	

■ ISO screw(R) is used.

Order form

Model

Materials

Sealant on R thread

RoHS-compliance

B	BsBM
S	SUS

C	Sealock processing
N	Normal type (No Sealock processing)

None	BsBM • SUS
Ro	Cd-less BsBM

Model			
TH 4-1/8	TH 9-3/8	TH 15-1/4	TH 22-1/2
TH 4-1/4	TH10-1/4	TH 15-3/8	TH 22-3/4
TH 6-1/4	TH10-3/8	TH 15-1/2	TH 22-1
TH 6-3/8	TH10-1/2	TH 15-3/4	TH 25-3/4
TH 8-1/4	TH12-1/4	TH 19-1/2	TH 25-1
TH 8-3/8	TH12-3/8	TH 19-3/4	TH 32-1 1/4
TH 9-1/4	TH12-1/2	TH 19-1	TH 32-1 1/2

RoHS-compliant type

Example: TH15-1/2-B-C-Ro

* Please contact our sales department for inquiries regarding date of delivery, etc.

■ Shape and specification may change without notice due to performance improvements.
 ■ Please contact us below for product-related inquiries, such as use of other materials.