

● Backs

The method of holding the dial gauge comes in two types; holding the stem and holding the lug of the back. However, the back may be replaced for convenience of holding.

① Center lug back



GB-1A

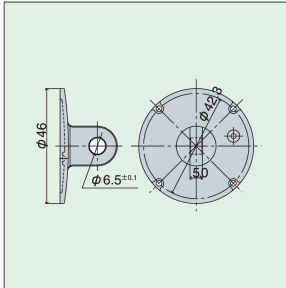

Part No.	Outer dia.	Dial Gauge installable
GB-1A	46.0	107. 107Z. 17Z. 57. 17. 17B. 5Z. 15Z. 207S. 207W. 18. 5B
GB-125	59.5	25. 55. 207
GB-1307	69.8	307
GB-1507	76.7	507. 509
GB-1809	105.0	809
GB-147	30.7	47. 47Z. 47SZ
GB-136	35.8	5S. 36A. 36B
GB-157S	35.3	57S
GB-1DX	50.2	55DX. 56. 107DX. 307S. 25S

② Flat back



GB-3A

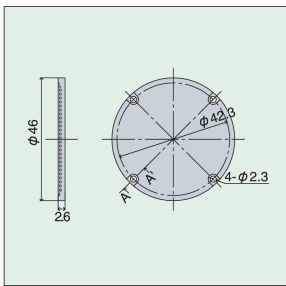

GB-3A	46.0	107. 107Z. 17Z. 57. 17. 17B. 5Z. 15Z. 207S. 207W. 18. 5B
GB-325	59.5	25. 207. 55
GB-3307	69.8	307
GB-3507	76.7	507. 509
GB-3809	105.0	809
GB-347	30.7	47. 47SZ. 47Z
GB-336	35.8	5S. 36A. 36B
GB-357S	35.3	57S
GB-3DX	50.2	55DX. 56. 107DX. 307S. 25S

③ Post back



GB-4A

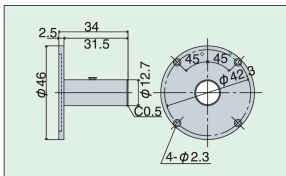

GB-4A	46.0	107. 107Z. 17Z. 57. 17. 17B. 5Z. 15Z. 207S. 207W. 18. 5B
GB-447	30.7	47. 47Z. 47SZ

④ Screw back



GB-5A

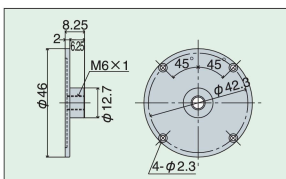

GB-5A	46.0	107. 107Z. 57. 17. 5B. 5Z. 17B. 15Z. 207S. 207W. 18
GB-547	30.7	47. 47Z. 47SZ
GB-536	35.8	5S. 36A. 36B
GB-557S	35.3	57S

⑤ Adjustable back



GB-6A

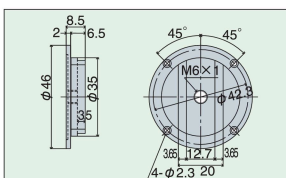

GB-6A	46.0	107. 107Z. 57. 17. 5B. 5Z.
GB-625	59.5	25. 55. 207
GB-647	30.7	47. 47Z. 47SZ
GB-636	35.8	5S. 36A. 36B
GB-657S	35.3	57S

⑥ Lug back with lever



GB-7A

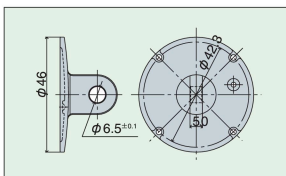

GB-7A	46.0	107. 107Z. 57. 17. 5B. 5Z. 17B. 15Z. 17Z. 18. 207S
--------------	------	--