

MUGEN-COATING 2-Flute Taper End Mill

CBN
Cubic Boron
Nitride

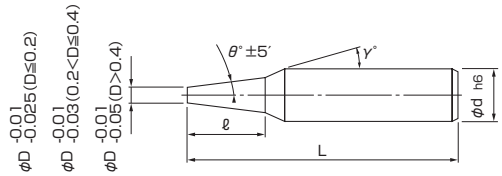

- 無限コーティングの採用で、テーパ加工も長寿命。
- サイズはφ0.2~φ10、片角30°~20°(φ6以下)までシリーズ化。
- MUGEN-COATING realizes long tool life at tapered cutting.
- Available from Dia. 0.2mm to Dia. 10mm and taper angle are from 30° to 20° (less than dia. 6).



被削材 Work Material									
炭素鋼 Carbon Steels	合金鋼・工具鋼 Alloy Steels・Tool Steels	予ハードン鋼・調質鋼 Prehardened Steels	焼き入れ鋼 Hardened Steels		ステンレス鋼 Stainless Steels	チタン合金 Titanium Alloy	アルミ合金 Aluminum	銅合金 Copper	樹脂 Plastic
◎	◎	◎	◎	◎	◎	○	◎	◎	◎

単位 [寸法 : mm / 価格 : 円]
Unit [size : mm / Retail Price : JPY]

コードNo. Code No.	(D)先端径 Dia.	(θ)片角 Taper Angle	(ℓ)刃長 Length of Cut	(d)大径径 Dia. at Large End	(γ)首角 Neck Taper Angle	(φ)シャンク径 Shank Dia.	(L)全長 Overall Length	標準価格 Retail Price	
08-00300-00202	0.2	30°	0.8	0.21	9°	4	45	13,000	
08-00300-00204		1°	0.8	0.23	9°	4	45	13,000	
08-00300-00205		1°30'	0.8	0.24	9°	4	45	13,000	
08-00300-00206		2°	0.8	0.26	9°	4	45	13,000	
08-00300-00208		3°	0.8	0.28	9°	4	45	13,000	
08-00300-00212		5°	0.8	0.34	9°	4	45	15,300	
08-00300-00219		10°	0.8	0.48	-	4	45	18,300	
08-00300-00302		0.3	30°	1.2	0.32	9°	4	45	10,800
08-00300-00304			1°	1.2	0.34	9°	4	45	10,800
08-00300-00305			1°30'	1.2	0.36	9°	4	45	10,800
08-00300-00306	2°		1.2	0.38	9°	4	45	10,800	
08-00300-00308	3°		1.2	0.43	9°	4	45	10,800	
08-00300-00312	5°		1.2	0.51	9°	4	45	12,600	
08-00300-00319	10°		1.2	0.72	-	4	45	15,300	
08-00300-00402	0.4		30°	1.6	0.43	9°	4	45	13,100
08-00300-00404			1°	1.6	0.46	9°	4	45	13,100
08-00300-00405			1°30'	1.6	0.48	9°	4	45	13,100
08-00300-00406		2°	1.6	0.51	9°	4	45	13,100	
08-00300-00408		3°	1.6	0.57	9°	4	45	13,100	
08-00300-00412		5°	1.6	0.68	9°	4	45	15,300	
08-00300-00419		10°	1.6	0.96	-	4	45	18,600	
08-00300-00502		0.5	30°	2	0.53	9°	4	45	10,800
08-00300-00504			1°	2	0.57	9°	4	45	10,800
08-00300-00505			1°30'	2	0.60	9°	4	45	10,800
08-00300-00506	2°		2	0.64	9°	4	45	10,800	
08-00300-00508	3°		2	0.71	9°	4	45	10,800	
08-00300-00510	4°		2	0.78	9°	4	45	11,700	
08-00300-00512	5°		2	0.85	9°	4	45	12,600	
08-00300-00514	6°		2	0.92	9°	4	45	13,500	
08-00300-00516	7°		2	0.99	9°	4	45	14,400	
08-00300-00519	10°		2	1.21	-	4	45	15,300	
08-00300-00524	15°	2	1.57	15°	4	45	16,400		
08-00300-00525	20°	2	1.96	15°	4	45	18,000		

コードNo. Code No.	(D)先端径 Dia.	(θ)片角 Taper Angle	(ℓ)刃長 Length of Cut	(d)大径径 Dia. at Large End	(γ)首角 Neck Taper Angle	(φ)シャンク径 Shank Dia.	(L)全長 Overall Length	標準価格 Retail Price	
08-00300-00602	0.6	30°	2	0.63	9°	4	45	10,100	
08-00300-00604		1°	2	0.67	9°	4	45	10,100	
08-00300-00605		1°30'	2	0.70	9°	4	45	10,100	
08-00300-00606		2°	2	0.74	9°	4	45	10,100	
08-00300-00608		3°	2	0.81	9°	4	45	10,100	
08-00300-00610		4°	2	0.88	9°	4	45	11,000	
08-00300-00612		5°	2	0.95	9°	4	45	11,900	
08-00300-00614		6°	2	1.02	9°	4	45	12,800	
08-00300-00616		7°	2	1.09	9°	4	45	13,700	
08-00300-00619		10°	2	1.31	-	4	45	14,600	
08-00300-00624	0.7	15°	2	1.67	15°	4	45	15,500	
08-00300-00625		20°	2	2.06	15°	4	45	16,400	
08-00300-00702		0.8	30°	2	0.73	9°	4	45	12,300
08-00300-00704			1°	2	0.77	9°	4	45	12,300
08-00300-00705			1°30'	2	0.80	9°	4	45	12,300
08-00300-00706			2°	2	0.84	9°	4	45	12,300
08-00300-00708			3°	2	0.91	9°	4	45	12,300
08-00300-00710			4°	2	0.98	9°	4	45	13,400
08-00300-00712			5°	2	1.05	9°	4	45	14,500
08-00300-00714			6°	2	1.12	9°	4	45	15,600
08-00300-00716	7°		2	1.19	9°	4	45	16,700	
08-00300-00719	10°		2	1.41	-	4	45	17,800	
08-00300-00724	0.8	15°	2	1.77	15°	4	45	18,900	
08-00300-00725		20°	2	2.16	15°	4	45	20,000	
08-00300-00802		0.8	30°	3	0.85	9°	4	45	10,100
08-00300-00804			1°	3	0.90	9°	4	45	10,100
08-00300-00805			1°30'	3	0.96	9°	4	45	10,100
08-00300-00806			2°	3	1.01	9°	4	45	10,100
08-00300-00808			3°	3	1.11	9°	4	45	10,100
08-00300-00810			4°	3	1.21	9°	4	45	11,000
08-00300-00812			5°	3	1.32	9°	4	45	11,900
08-00300-00814			6°	3	1.43	9°	4	45	12,800
08-00300-00816	7°		3	1.54	9°	4	45	13,700	
08-00300-00819	10°		3	1.86	-	4	45	14,600	
08-00300-00824	0.8	15°	3	2.41	15°	4	45	15,500	
08-00300-00825		20°	3	2.98	-	4	45	16,400	

オーダー方法 MTE230 先端径(D)×片角(θ)を指示して下さい。
When you order, indicate MTE230 (D)×(θ).

※(γ)は参考値です。
※(γ) is reference value.

●切削条件表はP361に記載
●Recommended Milling Conditions are shown on page 361.