

RoHS Compliant



No.E-659C



Q-Lock Elements/Bushes

(Screw Type/Pneumatic Type)

Material Main body: SCM440

Heat Treatment Main body: HRC55 heat treatment

Accessories Chip cover

Types and External Dimensions

Locate bush Clamp bush

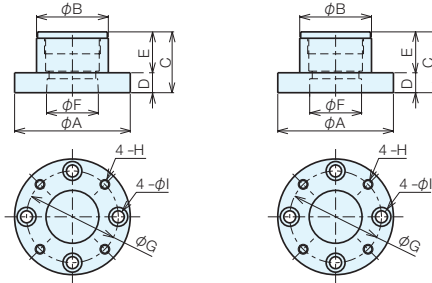

Bush Specifications

Type	Order No.	No.	A	B ⁰ _{-0.016}	C	D ± 0.005	E	F	G	H	I	Weight (g)
Locate Bush	66264	QLT19RB	45	27	24.5	7	17.5	19	36	M4 × 0.7	4.5	110
	66265	QLT26RB	58	36	30.5	10	20.5	26	46	M5 × 0.8	6	250
	66266	QLT32RB	72	45	37.5	12	25.5	32	58	M6 × 1.0	7	470
	67650	QLT40RB	88	58	46.5	15	31.5	40	72	M6 × 1.0	7	1000
Clamping Bush	66252	QLT19CB	45	27	24.5	7	17.5	18.5	36	M4 × 0.7	4.5	110
	66253	QLT26CB	58	36	30.5	10	20.5	25.5	46	M5 × 0.8	6	250
	66254	QLT32CB	72	45	37.5	12	25.5	31.5	58	M6 × 1.0	7	470
	67651	QLT40CB	88	58	46.5	15	31.5	39.5	72	M6 × 1.0	7	1000

Mounting Dimensions

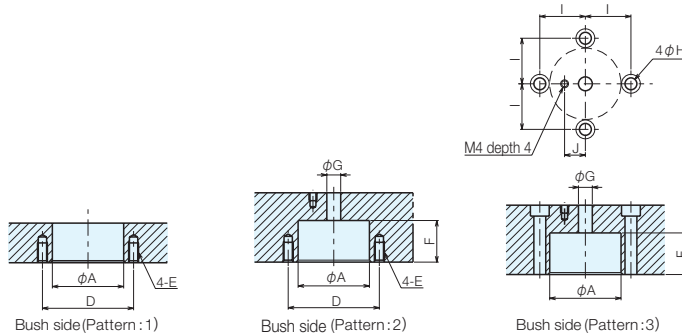

No.	A	Tolerance of A	E	F	G	H	I	J
QLT19	27	+0.033 +0.020	M4 depth 8	18.5	6.2	4.5	18	7.8
QLT26	36	+0.041 +0.025	M5 depth 10	21.5	7.3	6.0	23	10.5
QLT32	45	+0.041 +0.025	M6 depth 12	26.5	9.7	7.0	29	13.0
QLT40	58	+0.049 +0.030	M6 depth 12	32.5	12.0	7.0	36	13.0

* The pitch tolerance of ϕA is within ± 0.01 . (If ± 0.01 is exceeded, add an adjusting allowance by making the dimension of ϕA larger to match the pitch dimension.)

Base Elements

Clamp Units

Clamping Parts

Machine Vises

Drilling Vises

Vibration Isolation

Surface Plates and Measurement Instruments

Index