

TGY / TG Stainless Steel Pull



WEB Selection
Tool

WEB CAD
Download

SUS Stainless steel

TGY Male Screw

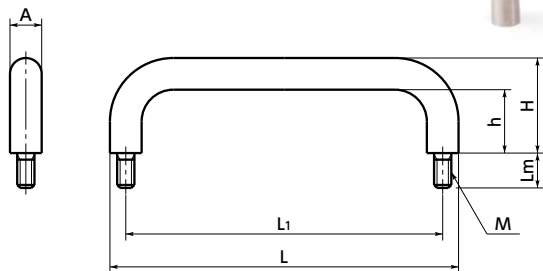

TG Female Screw

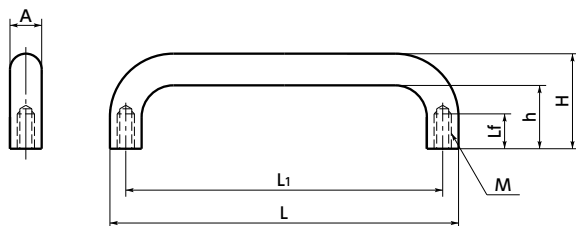

- Pull made of stainless steel.
 - Use it in combination with the washer **LY-N** (→ P.337).
*Washers are not supplied.
 - Male screw/female screw can be selected according to the product code. ◀ **1**
- TGY** — Male screw
TG — Female screw

- Material/Finish ● RoHS Compliant

| | TGY / TG |
|-----------|-------------------|
| Main body | SUS303 Buffing |

TGY Male Screw

Unit : mm

| Part Number | L ◀ 2 | A | L ₁ | H | h | L _m | M | Allowable load*1 (N) | Mass (g) | Applicable Washer |
|----------------|--------------|----|----------------|----|----|----------------|----|-------------------------|----------|-------------------|
| TGY-86 | 86 | 6 | 80 | 30 | 24 | 10 | M4 | 1000 | 30 | LY-10 |
| TGY-108 | 108 | 8 | 100 | 35 | 27 | 10 | M5 | 1000 | 62 | LY-12 |
| TGY-110 | 110 | 10 | 100 | 30 | 20 | 11 | M5 | 1000 | 89 | LY-16A |
| TGY-128 | 128 | 8 | 120 | 40 | 32 | 10 | M5 | 1000 | 74 | LY-12 |
| TGY-130 | 130 | 10 | 120 | 40 | 30 | 11 | M6 | 1000 | 114 | LY-16 |

*1 Allowed load for a person.

TG Female Screw

Unit : mm

| Part Number | L ◀ 2 | A | L ₁ | H | h | L _f | M | Allowable load*1 (N) | Mass (g) | Applicable Washer |
|---------------|--------------|----|----------------|----|----|----------------|------|-------------------------|----------|-------------------|
| TG-24 | 24 | 4 | 20 | 22 | 18 | 7 | M2.6 | 1000 | 4.5 | |
| TG-46 | 46 | 6 | 40 | 22 | 16 | 7 | M4 | 1000 | 14 | LY-10-N |
| TG-66 | 66 | 6 | 60 | 22 | 16 | 7 | M4 | 1000 | 18.5 | LY-10-N |
| TG-86 | 86 | 6 | 80 | 30 | 24 | 10 | M4 | 1000 | 26 | LY-10-N |
| TG-108 | 108 | 8 | 100 | 35 | 27 | 10 | M5 | 1000 | 55.5 | LY-12-N |
| TG-110 | 110 | 10 | 100 | 30 | 20 | 11 | M5 | 1000 | 82 | LY-16-N |
| TG-128 | 128 | 8 | 120 | 40 | 32 | 10 | M5 | 1000 | 68 | LY-12-N |
| TG-130 | 130 | 10 | 120 | 40 | 30 | 11 | M6 | 1000 | 104 | LY-16-N |

*1 Allowed load for a person.

- Part number specification

TG-24
◀ **1** ◀ **2**

Cleanroom Wash & Packaging → P.792

Laser Marking → P.806

Available / Add'l charge

Available / Add'l charge