



THN-65 PH

| item name | | wheel type | permissible load | wheel diameter | wheel width | high mount | mounting pitch | plate dimensions | mounting hole diameter | eccentricity |
|-----------------|-----------------|---|------------------|----------------|-------------|------------|------------------|------------------|------------------------|--------------|
| | | | daN | Dmm | mm | Hmm | A × B mm | X × Ymm | Pmm | Emm |
| THN-50 | HR | rubber, | 80 | | | | | | | |
| | PH | phenolic resin, | 150 | 50 | 28 | 68 | 54 × 36 | 70 × 54 | 6.5 | 25 |
| | NHG | strengthening black nylon | 150 | | | | | | | |
| THN-63 | NHG | strengthening black nylon | 210 | 63 | 36 | 89 | 76 × 44.5 | 95 × 70 | 8.7 | 25 |
| THN-65 | HR | rubber, | 110 | | 36 | | 91 × 64 | 111 × 86 | | |
| | PH | phenolic resin | 210 | | 38 | | 71 × 71 | 90 × 90 | | |
| | NHG | resin (with B), strengthening black nylon, | 210 | 65 | 36 | 92 | 71 × 71 | 90 × 90 | 10.5 | 25 |
| THN-P-65 | HR ※ | rubber, | 110 | | 36 | | 71 × 71 | 90 × 90 | | |
| THN-R-65 | PH ※ | fennel (with B) | 210 | | 38 | | 91 × 64 | 111 × 86 | | |
| THN-75 | HR | rubber, | 140 | | 36 | | 103 × 67 | 125 × 86 | | |
| | PH | phenolic resin (with B), | 220 | 75 | 38 | 106 | 71 × 71 | 90 × 90 | 10.5 | 28 |
| | THN-P-75 | HR ※ | rubber, | 140 | 36 | | 71 × 71 | 90 × 90 | | |
| THN-R-75 | PH ※ | phenolic resin (with B) | 220 | | 38 | | 103 × 67 | 125 × 86 | | |
| THN-100 | HR | rubber, | 170 | 100 | 38 | 130 | 103 × 67 | 125 × 86 | 10.5 | 28 |
| | PH | phenolic resin | 220 | | 32 | | | | | |

※ lot product

- Metal fittings are made of unichrome plating finish.
- THN and KHN types have the same mounting height
- (with B) means the wheel has a bearing(s).



HR



PH

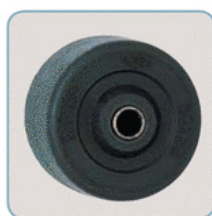

NHG



PH(100mm)

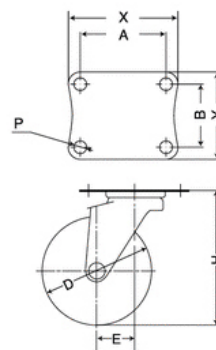

● southward locking mechanism (push down)



for details, refer to page 142