

■ Pipe adjuster

pipe diameter: 2 sizes for $\phi 12 \times \phi 16 \cdot \phi 16 \times \phi 19$

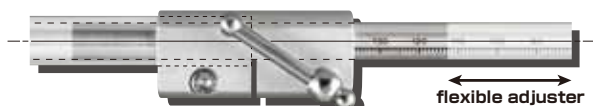

flexible adjuster

Handle is optional
(Refer to page 7)

Stretch joint by inserting small diameter pipe into big diameter pipe

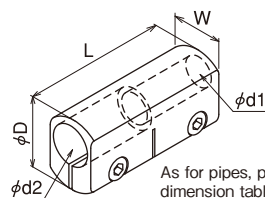

As for pipes, please refer to the MARU-pipe dimension table on page 97.

Part No.	$\phi d1$	$\phi d2$	ϕD	L	W	Cap screw	Horizontal load(N)	mass (g)
RAJ-1216	$\phi 12$	$\phi 16$	28	60	19	2-M5	544	31
RAJ-1619	$\phi 16$	$\phi 19.05$	33	70	24		735	56

■ Attachment bracket



Type 290

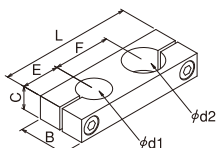

Type 425

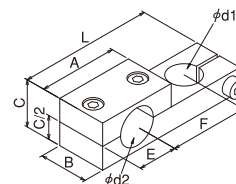

Part No.	$\phi d1$	$\phi d2$	L	B	C	E	F	Cap screw	mass (g)
FNG-290	$\phi 12$	$\phi 16$	60	20	12	16.5	25	M5	32
FLN-290	$\phi 16$	$\phi 19.1$	70	25	20	20	30		45

Part No.	$\phi d1$	$\phi d2$	L	A	B	C	E	F	Cap screw	mass (g)
FNG-425	$\phi 12$	$\phi 16$	72	40	20	20	20	35	M5	53
FLN-425	$\phi 16$	$\phi 19.1$	80	25	24	20	40	78		

Part No.

■ Attachment



Type 801

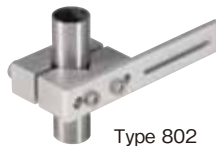
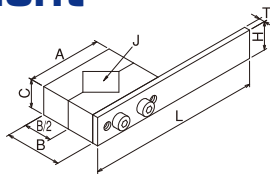

Type 802

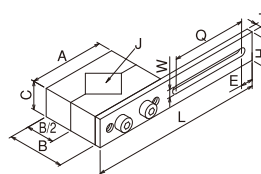

Part No.	Part No.	J (adaptive pipe)	L	A	B	C	H	T	E	Q	W (flute width)	Cap screw	mass (g)
FNG-801	FNG-802	$\phi 12 \sim 16$	72	32	24	12	12	3	5	30	3.2	M4	31
FLN-801	FLN-802	$\phi 16 \sim 20$	93	40	30	15	15		6.5	40	4.2		56



Type 803

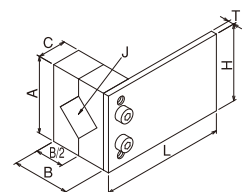

Part No.	J (adaptive pipe)	L	A	B	C	H	T	Cap screw	mass (g)
FNG-803	$\phi 12 \sim 16$	50	32	24	12	30	3	M4	36
FLN-803	$\phi 16 \sim 20$	65	40	30	15	40			65

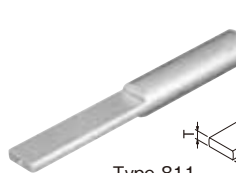

Type 811

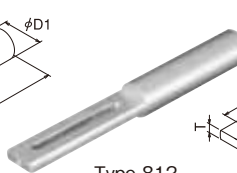
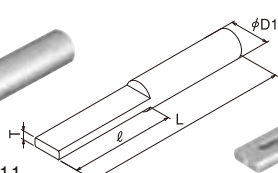

Type 812

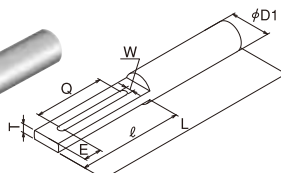

Part No.	Part No.	$\phi D1$ (h8)	L	l	T	E	Q	W (flute width)	mass (g)
FPG-811	FPG-812	$\phi 12$	80	40	4	5	30	3.2	18
FPN-811	FPN-812	$\phi 16$	120	60	5	10	40	4.5	47