

For slip prevention **SQ-500**
of positioning alignment

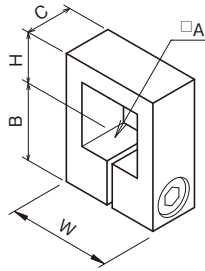

Stopper



Material A6063

	□A	B	H	C	W	Cap screw
SQ06-500	□ 6	10	6	8	15	M3
SQ08-500	□ 8	14	8	10	15	M4
SQ09-500	□ 9	14	8	10	15	M4
SQ10-500	□10	13	10	10	20	M4
SQ12-500	□12	16	10	10	20	M4
SQ13-500	□13	16	10	10	20	M4
SQ15-500	□15	19	13	12	25	M5
SQ16-500	□16	19	13	12	25	M5
SQ19-500	□19	21	15	12	30	M5
SQ20-500	□20	21	15	12	30	M5
SQ25-500	□25	26	20	15	40	M6

A pair use for parts attachment but one piece for light parts **SQ-503~8**



Rect-screw

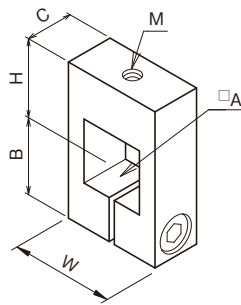

Material A6063

	□A	B	H	C	W	M	Cap screw
SQ06-503	□ 6	10	10	8	15	M3	M3
SQ08-503	□ 8	14	13	10	15	M3	M4
SQ08-504						M4	
SQ09-503	□ 9	14	13	10	15	M3	M4
SQ09-504						M4	
SQ10-503	□10	13	15	10	20	M3	M4
SQ10-504						M4	
SQ12-503	□12	16	14	10	20	M3	M4
SQ12-504						M4	
SQ13-503	□13	16	16	10	20	M3	M4
SQ13-504						M4	
SQ15-504	□15	19	20	12	25	M4	M5
SQ15-505						M5	
SQ16-504	□16	19	20	12	25	M4	M5
SQ16-505						M5	
SQ19-505	□19	21	25	12	30	M5	M5
SQ19-506						M6	
SQ20-505	□20	21	25	12	30	M5	M5
SQ20-506						M6	
SQ25-506	□25	26	30	15	40	M6	M6
SQ25-508						M8	

A part can be fixed more firmly with the screws of two points. **SQ-534~6**



Rect-screw

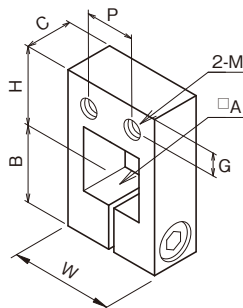

Material A6063

	□A	B	H	C	W	M	P	G	Cap screw
SQ08-534	□ 8	13	25	10	20	M4	10	5	M4
SQ09-534	□ 9			12					
SQ10-534	□10			12					
SQ12-534	□12	15	32	15	28	M5	15	7	M5
SQ13-534	□13								
SQ15-535	□15	22	38	15	30	M6	18	8	M5
SQ16-535	□16								
SQ19-536	□19								
SQ20-536	□20								