

Strong Type B-GX

- Please read "request and advice for order" in page 6 before placing an order.
- Please refer to "joint boot" in page 24 and 25.

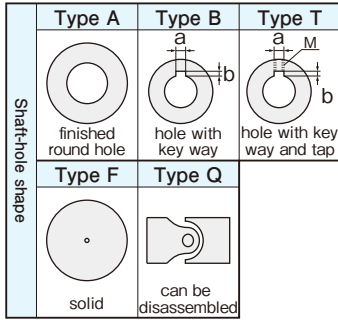

Standard Part

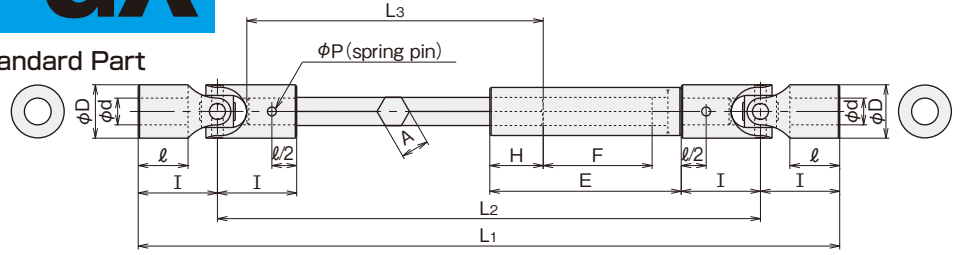

With Key Tap (B-GX TT)

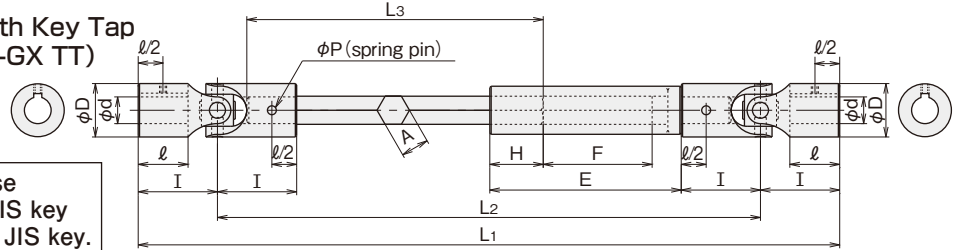

Choose new JIS key or old JIS key.

Dimension L1 can be changed as a special order.

Type B-GX Dimension Table

standard part's attachment ● spring-pin 2 pieces

Symbol Size	ϕd^{H7}	ϕD	I	l	E	H	F Slide distance	A	Dimension of spring-pin for fixing	New JIS key		Old JIS key		TAP M	MAX				MIN
										a ^{JS9}	b	a ^{JS9}	b		L1 ⁰	L2	L3	L1 ¹	
B- 6GX	6	12	25	18	85	15	60	6.7	2 ×12	2	1.0	2	1.0	M3	270	220	118	162	
B- 8GX	8	16	28	19	85	20	55	7.7	2.5×16	3	1.4	3	1.5	M3	277	221	119	180	
B-10GX	10	20	34	23	105	20	75	9.8	3 ×20	3	1.4	4	1.5	M4	321	253	123	212	
B-12GX	12	24	42	29	108	25	70	11.7	4 ×25	4	1.8	4	1.5	M4	351	267	129	264	
B-14GX	14	28	47	31.5	128	30	80	13.7	5 ×28	5	2.3	5	2.0	M5	436	342	181.5	299	
B-16GX	16	32	52	34.5	128	35	75	16.7	5 ×32	5	2.3	5	2.0	M5	451	347	184.5	330	
B-18GX	18	36	60	40	150	40	90	18.7	6 ×36	6	2.8	5	2.0	M6	500	380	190	380	
B-20GX	20	40	62	40	170	40	110	20.7	6 ×40	6	2.8	5	2.0	M6	528	404	190	388	
B-22GX	22	44	65	41	190	45	125	22.6	6 ×45	6	2.8	7	3.0	M8	605	475	241	407	
B-25GX	25	50	70	43	215	50	140	25.6	8 ×50	8	3.3	7	3.0	M8	645	505	243	441	
B-30GX	30	60	89	56	215	60	130	31.6	10 ×60	8	3.3	7	3.0	M8	711	533	256	553	

● MAX L1=Maximum length in which the sliding stroke F of standard part is kept. ● MIN L1=Minimum length in which a shaft and a sleeve are cut and the engaged distance H and sliding stroke l are kept.

Anti-wear Type HJ-GX

- Please read "request and advice for order" in page 6 before placing an order.
- Please refer to "joint boot" in page 24 and 25.

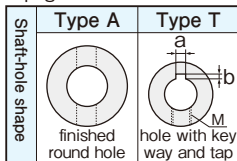

Standard Part

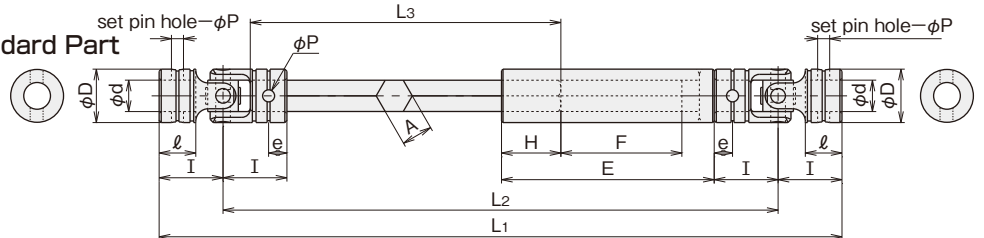

With Key Tap (HJ-GX TT)

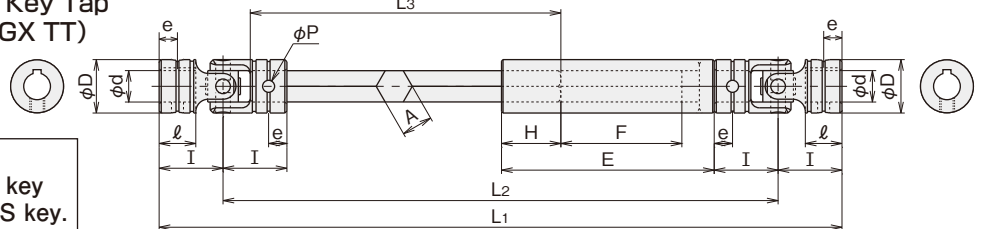

Choose new JIS key or old JIS key.

Dimension L1 can be changed as a special order.

Type HJ-GX Dimension Table

standard part's attachment ● strong-pin 2 pieces ● check ring 2 pieces

Symbol Size	ϕd^{H7}	ϕD	I	l	E	H	F Slide distance	A	e	ϕP_{m6}^{H8}	New JIS key		Old JIS key		TAP M	MAX				MIN
											a ^{E9}	b	a ^{E9}	b		L1 ⁰	L2	L3	L1 ¹	
HJ- 6GX	6	12	15.5	9	85	15	60	6.7	4.5	3	—	—	—	—	—	232	201	109	105	
HJ- 8GX	8	15	18	10	85	20	55	7.7	5	3.5	3	1.4	3	1.5	M3	237	201	110	122	
HJ-10GX	10	19	21	12	105	20	75	9.8	6	4.5	3	1.4	4	1.5	M4	269	227	112	136	
HJ-12GX	12	23	26	15	108	25	70	11.7	7.5	5	4	1.8	4	1.5	M4	287	235	115	168	
HJ-14GX	14	26	29.5	16	128	30	80	13.7	8.5	5.8	5	2.3	5	2.0	M5	366	307	166	198	
HJ-16GX	16	30	37	20	128	35	75	16.7	11	6.5	5	2.3	5	2.0	M5	391	317	170	241	
HJ-18GX	18	33	40.5	23.5	150	40	90	18.7	11.7	7	6	2.8	5	2.0	M6	422	341	173.5	269	
HJ-20GX	20	36	43.5	25	170	40	110	20.7	12.5	8	6	2.8	5	2.0	M6	454	367	175	284	
HJ-22GX	22	40	47	27	190	45	125	22.6	13.5	9	6	2.8	7	3.0	M8	533	439	227	307	
HJ-25GX	25	44	52.5	30	215	50	140	25.6	15	10	8	3.3	7	3.0	M8	575	470	230	345	
HJ-30GX	30	51	61	35	215	60	130	31.6	17.5	11.5	8	3.3	7	3.0	M8	599	477	235	399	

● MAX L1=Maximum length in which the sliding stroke F of standard part is kept. ● MIN L1=Minimum length in which a shaft and a sleeve are cut and the engaged distance H and sliding stroke l are kept.