

# DC1

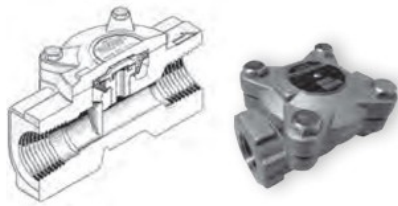

Capacity Chart DC1

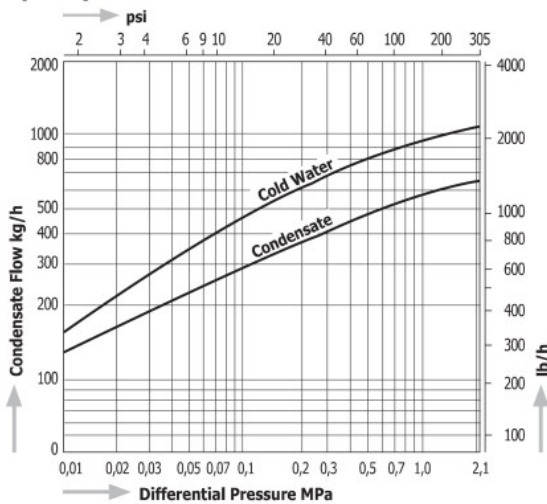

# DC2

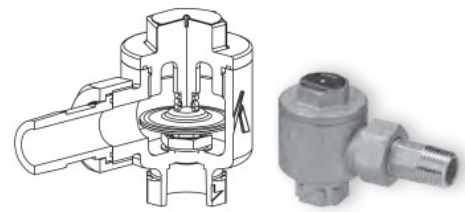

Capacity Chart DC2

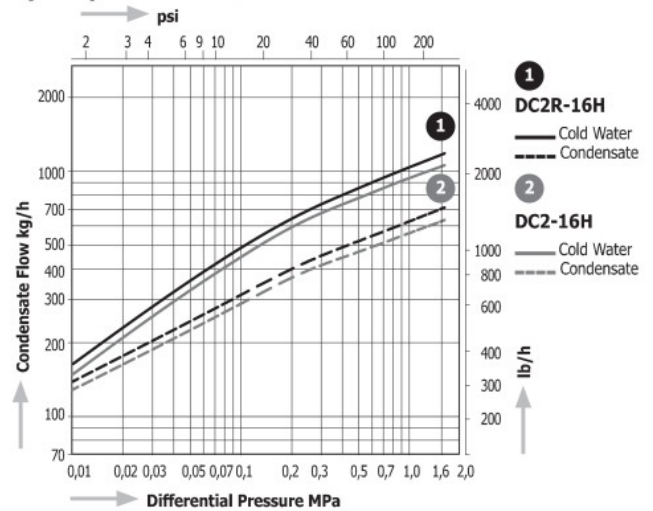

# DV1 with Bypass Valve

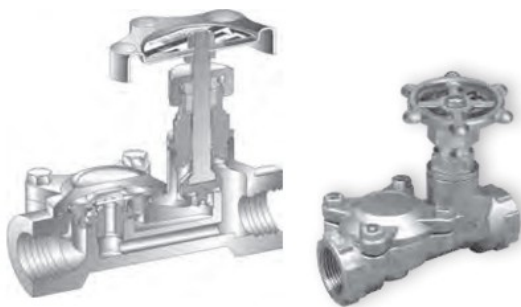

Capacity Chart DV1

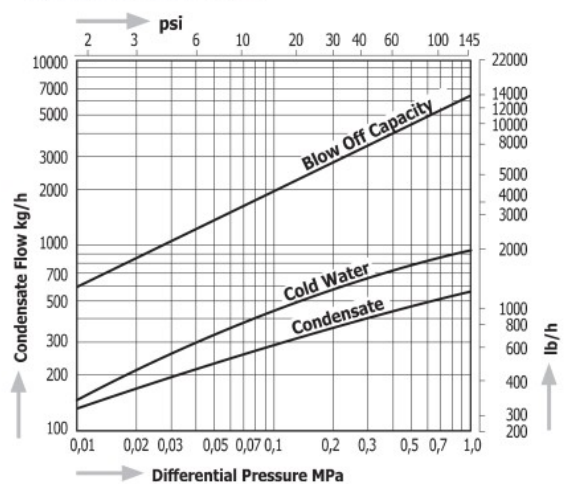

Dimensions

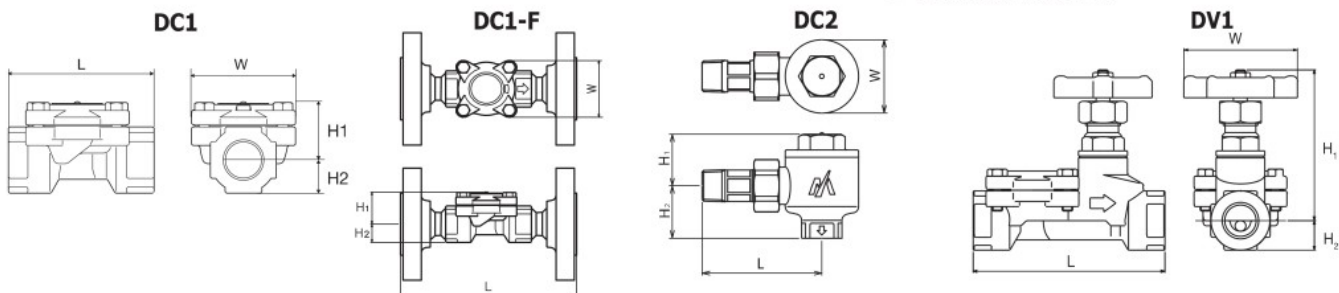

Model	Connections	Size	Max. Operating Pressure		Max. Operating Temperature		Dimensions (mm)				Dimensions (in)				Body Material	Weight	
			MPa	psig	°C	°F	L	H <sub>1</sub>	H <sub>2</sub>	W	L	H <sub>1</sub>	H <sub>2</sub>	W		kg	lb
DC1-21H DC1-21L	Screwed Rc, NPT	1/4", 3/8"	2,1	305	220	428	65	29	11	53	2.6	1.1	0.4	2.1	Stainless Steel SCS13A	0,4	0.9
		1/2", 3/4"					75	31	17		3.0	1.2	0.7			0,5	1.1
		1"					80	34	21		3.1	1.3	0.8			0,5	1.1
DC1-21HF DC1-21LF	Flanged JIS, ASME, DIN	1/2"	2,1	305	220	428	150	31	17	53	5.9	1.2	0.7	2.1	Stainless Steel SCS13A	1,3	2.9
		3/4"					160	34	21		6.3	1.3	0.8			2,2	4.9
		1"					160	34	21		6.3	1.3	0.8			3,1	6.8
DC2R-16H DC2-16H	Inlet: R Outlet: Rc, NPT	1/2"	1,6	230	220	428	80	35	35	49	3.1	1.4	1.4	1.9	Stainless Steel SCS13A	0,7	1.5
DV1-10	Screwed Rc, NPT	1/2", 3/4"	1,0	145	185	365	110	88	17	65	4.3	3.5	0.7	2.6	Stainless Steel SCS13A	0,9	1.9

DC2R-16H – Type with bypass orifice to prevent residue of condensate in steam traps.