

BLADE

Section of blade

Single blade

Standard

Full-flush round type

Full-flush flat type

S Type



Standard Blades

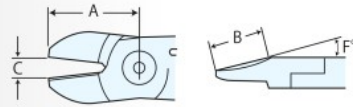

Model	Dimensions (mm)				Section of blade
	A	B	C	F°	
S20	24.0	12.0	2.5	25	Single blade
S2	24.0	12.0	3.0	25	Single blade
S4	27.0	14.0	5.0	25	Single blade
S5A	35.0	17.0	5.5	30	Single blade
S5	35.0	17.0	7.0	30	Single blade
S250	43.0	20.0	10.0	15	Single blade
S7P1	43.0	20.0	7.0	30	Single blade
S9P1	65.0	38.0	12.0	15	Single blade
S7P	43.0	20.0	7.0	30	Single blade
S9P	66.0	38.0	16.0	15	Single blade
S120	45.0	22.0	9.0	35	Standard

CR Type



Clipper edge

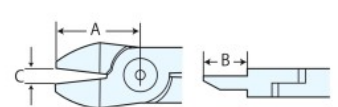

Model	Dimensions (mm)			Section of blade
	A	B	C	
CR20	24.0	13.0	2.5	Single blade
CR2	24.0	13.0	3.0	Single blade
CR4	27.0	12.5	4.5	Single blade
CR6A	35.0	18.0	5.0	Single blade
CR6	35.0	18.0	7.0	Single blade
CR250	43.0	22.0	11.0	Single blade
CR8P1	43.0	23.0	7.0	Single blade
CR8P	43.0	23.0	7.0	Single blade
CR120	60.0	35.0	11.0	Standard

S-S Type

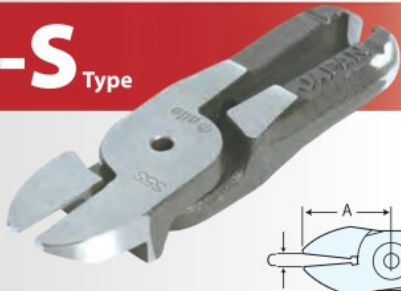

Flat surface

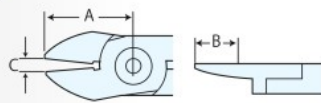

Model	Dimensions (mm)			Section of blade
	A	B	C	
S20S	24.0	12.0	2.5	Single blade
S2S	24.0	12.0	3.0	Single blade
S4S	27.0	13.0	5.0	Single blade
S5AS	35.0	17.0	5.5	Single blade
S5S	35.0	17.0	7.0	Single blade
S250S	43.0	23.0	10.0	Single blade
S7P1S	43.0	22.0	7.0	Single blade
S7PS	43.0	20.0	7.0	Single blade
S9PS	66.0	37.0	16.0	Single blade
S120S	55.0	30.0	10.0	Standard

EP Type

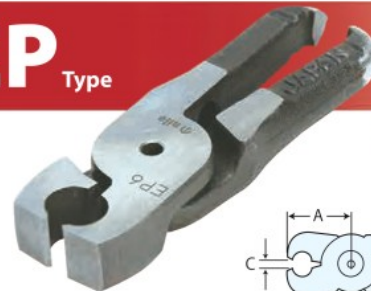

End cutting edge

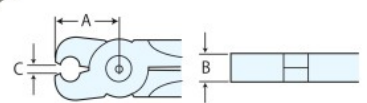

Model	Dimensions (mm)			Section of blade
	A	B	C	
EP20	20.0	7.0	2.0	Standard
EP2	20.0	7.0	2.5	Standard
EP4	26.0	9.0	4.5	Standard
EP6A	28.0	12.0	4.5	Standard
EP6	28.0	12.0	5.5	Standard
EP10P1	34.0	17.0	5.5	Standard
EP10P	34.0	17.0	5.5	Standard
EP120	40.0	25.0	8.0	Standard

P Type



Heavy-duty

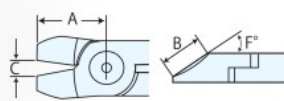

Model	Dimensions (mm)				Section of blade
	A	B	C	F°	
P6A	29.0	12.0	4.5	35	Single blade
P6	29.0	11.0	6.0	35	Standard
P8P1	37.0	12.0	5.0	25	Standard
P8P1S	37.0	15.0	5.0	-	Standard
P8P	37.0	12.0	6.0	25	Standard
P8PS	37.0	12.0	6.0	-	Standard
P120	40.0	16.0	8.0	35	Standard

Z Type

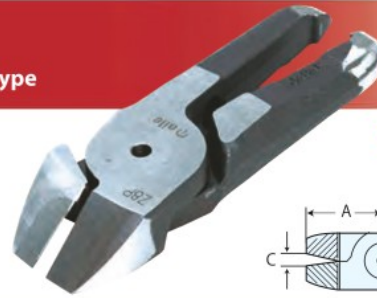

Carbide tipped for hard wire

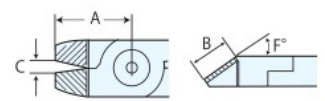

Model	Dimensions (mm)				Section of blade
	A	B	C	F°	
Z20	24.0	11.0	2.5	25	Single blade
Z2	24.0	11.0	3.0	25	Single blade
Z4	27.0	10.0	5.0	25	Single blade
Z6A	30.0	15.0	5.0	35	Standard
Z6	30.0	15.0	6.0	35	Standard
Z8P1	38.0	20.0	5.0	40	Standard
Z57P	43.0	20.0	7.0	30	Standard
Z8P	38.0	20.0	6.0	40	Standard
Z120	40.0	17.0	7.0	35	Standard