

Article number	Article designation	For mm <sup>2</sup>	UL certification	Connection bolt	Core colour	Pieces / PU
<b>Pin cable lugs</b>						
63107010	L-RZP	0.25 - 0.75	no		green	100
63107020	L-RAP	0.5 - 1.5	yes		red	100
63107040	L-RBP	1.5 - 2.5	yes		blue	100
63107070	L-RCP	4 - 6	yes		yellow	100
<b>Circular connector</b>						
63110010	L-RABM	0.5 - 1.5	no		red	100
63110020	L-RB 5 BM	1.5 - 2.5	no		blue	100
<b>Connector sleeve</b>						
63111010	L-RAB	0.5 - 1.5	no		red	100
63111020	L-RB 5 B	1.5 - 2.5	no		blue	100
<b>Butt connector</b>						
63106020	L-RAA 15	0.5 - 1.5	yes		red	100
63106040	L-RBB 25	1.5 - 2.5	yes		blue	100
63106080	L-RCC 6	4 - 6	yes		yellow	50
<b>End joint</b>						
63112010	L-RBJ	1.5 - 2.5	no		transparent	100
63112020	L-RCJ	4 - 6	no		transparent	50

Other sizes and colours are available upon request.  
 Photographs are not to scale and do not represent detailed images of the respective products.  
 Production tolerance ± 0,5 mm

### Solderless cable lugs KB

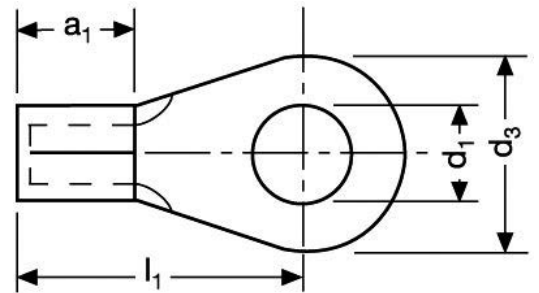

#### Benefits

- For first-class connection with simple operating principle
- Thus providing the best electrical conductivity (least resistance)

#### Application range

- For cables with category 2,5 and 6 conductors
- Manufacturing of control cabinets and equipment
- Trains and buses

#### Norm references / Approvals

- In accordance with VG 88710
- Coil form DIN 46234, non-insulated

#### Note

- For processing tools see the keyword index "crimping pliers for other connections"

#### Suitable tools

- PEW 12 universal tool refer to page 1034
- V 1311-A pressing pliers, hydraulic refer to page 1030
- DKB 0325 + DKB 0360 crimping pliers refer to page 1026

#### Technical data

**ETIM** ETIM 5.0 Class-ID: EC001052  
 ETIM 5.0 Class-Description: Solderless copper terminals for copper conductors

**Note**  
 s = thickness of material

**Material**  
 High-quality electrolytic copper for good conductivity

**Temperature range**  
 Max. temperature: +120°C (short-term)  
 Temperature range up to +90°C

Article number	Article designation	For mm <sup>2</sup>	UL certification	AWG	Nominal size	d1	d3	l1	a1	s	Pieces / PU
<b>Solderless cable lugs KB</b>											
63204015	KB1-2,5R DIN 46234	0.5 - 1.5	no	22-16	2.5-1.0	2.8	6	11	5		100
63204025	KB1-3R DIN 46234	0.5 - 1.5	no	22-16	3.2-1.0	3.2	6	11	5	0.8	100
63204035	KB1-3,5R DIN 46234	0.5 - 1.5	no	22-16	3.5-1.0	3.7	6	11	5	0.8	100
63204045	KB1-4R DIN 46234	0.5 - 1.5	no	22-16	4.0-1.0	4.3	8	12	5	0.8	100
63204055	KB1-5R DIN 46234	0.5 - 1.5	no	22-16	5.0-1.0	5.3	10	13	5	0.8	100
63204065	KB1-6R DIN 46234	0.5 - 1.5	no	22-16	6.0-1.0	6.5	10	13	5	0.8	100
63204075	KB1-8R DIN 46234	0.5 - 1.5	no	22-16	8.0-1.0	8.4	14	17	5	0.8	100
63204085	KB1-10R DIN 46234	0.5 - 1.5	no	22-16	10.0-1.0	10.5	14	17	5	0.8	100
63204095	KB2,5-3R DIN 46234	1.5 - 2.5	no	16-14	3.0-2.5	3.2	6	11	5	0.8	100
63204105	KB2,5-3,5R DIN 46234	1.5 - 2.5	no	16-14	3.5-2.5	3.7	6	11	5	0.8	100
63204115	KB2,5-4R DIN 46234	1.5 - 2.5	no	16-14	4.0-2.5	4.3	8	12	5	0.8	100
63204125	KB2,5-5R DIN 46234	1.5 - 2.5	no	16-14	5.0-2.5	5.3	10	14	5	0.8	100
63204135	KB2,5-6R DIN 46234	1.5 - 2.5	no	16-14	6.0-2.5	6.5	11	16	5	0.8	100
63204145	KB2,5-8R DIN 46234	1.5 - 2.5	no	16-14	8.0-2.5	8.4	14	17	5	0.8	100
63204155	KB2,5-10R DIN 46234	1.5 - 2.5	no	16-14	10.0-2.5	10.5	14	17	5	0.8	100
63204165	KB2,5-12R DIN 46234	1.5 - 2.5	no	16-14	12.0-2.5	13	18	20	5	0.8	100
63204175	KB6-4R DIN 46234	2.5 - 6	no	12-10	4.0-6.0	4.3	8	14	6	1	100
63204185	KB6-5R DIN 46234	2.5 - 6	no	12-10	5.0-6.0	5.3	10	15	6	1	100