

SUS2052B



SUS Standard Stainless Steel Double Pitch Sprocket for R Rollers B-type

Order No. Example

SUS 2052B 12

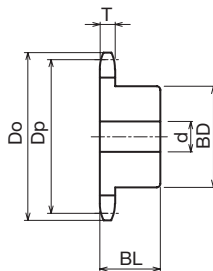
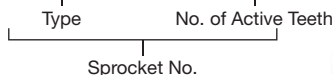

- Chain No.C2052
- Chain Pitch (P)31.75mm
- Roller Link Inner Width (W) 9.53mm
- Roller Outside Diameter (Dr)19.05mm
- Tooth Width (T) 8.7 mm

m Stainless Steel **GB** 304

Type	Action No. of Teeth	Outer Diameter Do	Pitch Diameter Dp	Shaft Hole Diameter d			Boss Diameter BD	Boss Length BL	Shape	Weight kg	¥	Semi-F ¥
				Prepared Holes	Minimum	Maximum						
SUS 2052B	10	116	102.75	20	21	48	73	28	Ground Specification	1.10		
	11	127	112.70	20	21	48	73	28		1.20		
	12	138	122.67	20	21	48	73	28		1.30		
	13	148	132.67	20	21	48	73	28		1.50		



Order Method

Sprocket No. and Quantity



Postage

Same-day shipping



Guide

* Since we also manufacture sizes other than those in the catalog, and machine shaft holes/keys/taps, etc., depending on your request, please contact our company's sales office for details.

* Please refer to P24 to P33 for the Semi-F Series <Complete Product> order method.

Semi-F Series
FITLINK
Roller
Chains
Chain
Accessories
Idlers &
Tensioners
Sprockets
Oilless
Bushings
Transmission
Accessories
Conveyor Chains/
Sprockets
Chain
Couplings
Roller
Halls
Triple Speed/Center
[Transp] Chains
Timing Belts/
Pulleys/Flanges
Shaft Collars
Pinions/Racks/
Miter Gears
Imperfect
Products