

NK100B / NK100C

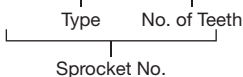

● Order No. Example

NK100B 20



Ground Specification



Welded Specification

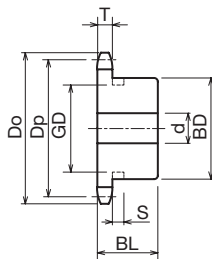

B-Type Ground Specification

- Chain No.100
- Chain Pitch (P)31.75mm
- Roller Link Inner Width (W)19.05mm
- Roller Outside Diameter (Dr)19.05mm
- Tooth Width (T)17.6 mm

Sprocket No.		Outer Diameter Do	Pitch Diameter Dp	Shaft Hole Diameter d			Boss Diameter BD	Boss Length BL	Shape	Material	Weight kg	¥	Semi-F ¥
Type	No. of Teeth			Prepared Hole Product	Minimum	Maximum							
NK 100B	9	106	92.84	20	21	40	★70	50	Ground Specification	h m Carbon Structural Steel High-frequency Hardened Teeth	1.6		
	10	117	102.74	20	21	45	65	50			1.9		
	11	127	112.70	20	21	51	75	50			2.3		
	12	138	122.67	20	21	57	86	50			2.9		
	13	148	132.67	20	21	63	94	50			3.1		
	14	158	142.68	20	21	66	98	50	3.6				
	15	168	152.71	20	21	66	98	50	4.2				
	16	179	162.74	20	21	66	98	50	4.6				
	17	189	172.79	20	21	75	107	50	5.3				
	18	199	182.84	20	21	75	107	50	5.7				
	19	209	192.90	20	21	75	107	50	6.1				
	20	220	202.96	20	21	75	107	50	6.5				
	21	230	213.03	20	21	75	107	50	7.0				
	22	240	223.10	26	27	80	117	56	Ground Specification	E Com- mon Steel	7.9		
	23	250	233.17	26	27	80	117	56			8.5		
24	260	243.25	26	27	80	117	56	8.8					
25	270	253.32	26	27	80	117	56	9.3					
26	281	263.40	26	27	80	117	56	Welded Specification	E Common Steel	9.8			
27	291	273.49	26	27	80	117	56			10.3			
28	301	283.57	26	27	80	117	56			10.9			
29	311	293.66	26	27	80	117	56			11.5			
30	321	303.75	26	27	80	117	56			12.1			