

# SUS40B



## SUS Stainless Steel Sprocket B-type

### Order No. Example

**SUS40B 20**

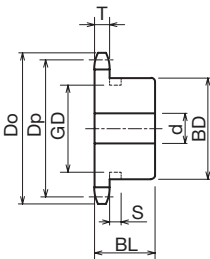
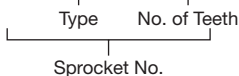

Sprockets with a ★ symbol for BD have a channel in the boss exterior.

| No. of Teeth | S   | GD |
|--------------|-----|----|
| 10           |     | 27 |
| 11           | 5.2 | 31 |
| 12           | 5.2 | 35 |

- Chain ..... No.40
- Chain Pitch ..... (P)12.70mm
- Roller Link Inner Width ..... (W) 7.95mm
- Roller Outside Diameter ..... (Dr) 7.92mm
- Tooth Width ..... (T) 7.2 mm

Stainless Steel GB304

| Type       | No. of Teeth | Outer Diameter Do | Pitch Diameter Dp | Shaft Hole Diameter d |         |         | Boss Diameter BD | Boss Length BL | Shape                | Weight kg | ¥ | Semi-F |
|------------|--------------|-------------------|-------------------|-----------------------|---------|---------|------------------|----------------|----------------------|-----------|---|--------|
|            |              |                   |                   | Prepared Hole Product | Minimum | Maximum |                  |                |                      |           |   | ¥      |
| SUS<br>40B | 10           | 47                | 41.10             | 9                     | 10      | 18      | ★32              | 22             | Ground Specification | 0.14      |   |        |
|            | 11           | 51                | 45.08             | 10                    | 11      | 20      | ★36              | 22             |                      | 0.19      |   |        |
|            | 12           | 55                | 49.07             | 10                    | 11      | 22      | ★40              | 22             |                      | 0.22      |   |        |
|            | 13           | 59                | 53.07             | 12                    | 13      | 20      | 37               | 22             |                      | 0.23      |   |        |
|            | 14           | 63                | 57.07             | 12                    | 13      | 25      | 42               | 22             |                      | 0.28      |   |        |
|            | 15           | 67                | 61.08             | 12                    | 13      | 28      | 46               | 22             |                      | 0.34      |   |        |
|            | 16           | 71                | 65.10             | 13                    | 14      | 30      | 50               | 22             |                      | 0.40      |   |        |
|            | 17           | 76                | 69.12             | 13                    | 14      | 32      | 54               | 22             |                      | 0.46      |   |        |
|            | 18           | 80                | 73.14             | 13                    | 14      | 35      | 57               | 22             |                      | 0.51      |   |        |
|            | 19           | 84                | 77.16             | 14                    | 15      | 40      | 62               | 22             |                      | 0.59      |   |        |
|            | 20           | 88                | 81.18             | 14                    | 15      | 45      | 67               | 25             |                      | 0.76      |   |        |
|            | 21           | 92                | 85.21             | 14                    | 15      | 48      | 71               | 25             |                      | 0.85      |   |        |
|            | 22           | 96                | 89.24             | 14                    | 15      | 51      | 75               | 25             |                      | 0.95      |   |        |
|            | 23           | 100               | 93.27             | 14                    | 15      | 51      | 77               | 25             |                      | 1.00      |   |        |
|            | 24           | 104               | 97.30             | 14                    | 15      | 42      | 63               | 25             |                      | 0.84      |   |        |
|            | 25           | 108               | 101.33            | 14                    | 15      | 42      | 63               | 25             |                      | 0.88      |   |        |
|            | 26           | 112               | 105.36            | 14                    | 15      | 42      | 63               | 25             |                      | 0.92      |   |        |
|            | 27           | 116               | 109.40            | 14                    | 15      | 42      | 63               | 25             |                      | 0.96      |   |        |
|            | 28           | 120               | 113.43            | 14                    | 15      | 42      | 63               | 25             |                      | 1.00      |   |        |
|            | 30           | 128               | 121.50            | 14                    | 15      | 42      | 63               | 25             |                      | 1.10      |   |        |
| 32         | 137          | 129.57            | 14                | 15                    | 45      | 68      | 28               | 1.30           |                      |           |   |        |
| 34         | 145          | 137.64            | 14                | 15                    | 45      | 68      | 28               | 1.30           |                      |           |   |        |
| 35         | 149          | 141.68            | 14                | 15                    | 45      | 68      | 28               | 1.40           |                      |           |   |        |
| 36         | 153          | 145.72            | 16                | 17                    | 45      | 68      | 28               | 1.50           |                      |           |   |        |
| 38         | 161          | 153.79            | 16                | 17                    | 45      | 68      | 28               | 1.60           |                      |           |   |        |
| 40         | 169          | 161.87            | 16                | 17                    | 45      | 68      | 28               | 1.70           |                      |           |   |        |



Order Method

Sprocket No. and Quantity



Guide

\* Since we also manufacture sizes other than those in the catalog, and machine shaft holes/keys/taps, etc., depending on your request, please contact our company's sales office for details.



Postage

Same-day shipping

\* Please refer to P24 to P33 for the Semi-F Series <Complete Product> order method.