

C-type Double Idler Sprocket

● Order No. Example

WID 40C 15 D15

Type No. No. of Teeth D
Sprocket No.

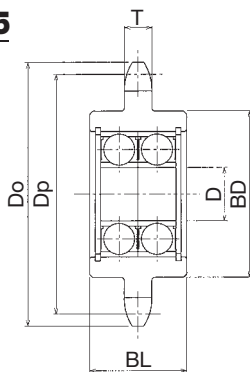

The KANA standard W (double) idler sprocket holds tension at the appropriate level during roller chain transmission.

Because of its hardened teeth, the sprocket features excellent durability and quiet rotation. The bearing is located in the center of the sprocket.

- m Carbon Structural Steel
- h High-frequency Hardened Teeth
- s Black Oxide Finish

Type	No.	No. of Teeth	Inner Diameter D	Outer Diameter Do	Pitch Diameter Dp	Tooth Width T	Boss BD	Total Width BL	Used Bearing	Weight kg	Idler Pin Applicable Size	ID Adapter Applicable Size	¥
WID	35C	16	10/12	54	48.82	4.3	38	22	6000ZZ 6001ZZ	0.13 0.12	IDP6000W IDP6001W	AD6000 AD6001	
		18	15	60	54.85		44	28	6202ZZ	0.21	IDP6202W	AD6202	
		21	17	69	63.91		53	31	6203ZZ	0.31	IDP6203W	AD6203	
		25	20	81	76.00		60	35	6204ZZ	0.44	IDP6204W	AD6204	
	40C	13	10/12	59	53.07	7.2	38	22	6000ZZ 6001ZZ	0.17 0.16	IDP6000W IDP6001W	AD6000 AD6001	
		15	15	67	61.08		44	28	6202ZZ	0.25	IDP6202W	AD6202	
		17	17	76	69.12		53	31	6203ZZ	0.37	IDP6203W	AD6203	
	50C	12	12	69	61.34	8.7	43	26	6201ZZ	0.25	IDP6201W	AD6201	
		13	15	74	66.34		44	28	6202ZZ	0.28	IDP6202W	AD6202	
		15	17	84	76.35		53	31	6203ZZ	0.44	IDP6203W	AD6203	
		17	20	94	86.39		60	35	6204ZZ	0.60	IDP6204W	AD6204	
	60C	11	12/15	76	67.62	11.7	44	26	6201ZZ	0.30	IDP6201W	AD6201	
		13	17	89	79.60		53	31	6203ZZ	0.53	IDP6203W	AD6203	
		14	20	95	85.61		60	35	6204ZZ	0.67	IDP6204W	AD6204	
		13	17	89	79.60		53	31	6203ZZ	0.53	IDP6203W	AD6203	
	80C	9	15	85	74.27	14.6	44	28	6202ZZ	0.43	IDP6202W	AD6202	
		10	17	93	82.20		52	31	6203ZZ	0.64	IDP6203W	AD6203	
		11	20	102	90.16		60	35	6204ZZ	0.80	IDP6204W	AD6204	



Sprocket No. and Quantity



Same-day shipping



* The bearing is located in the center of the sprocket. With a view to improving quality even further, we are shifting over from the conventional one-spot snap ring fastening to a two-spot fastening as shown in the dimensional drawing. Because of this changeover, please note that there may be a mixture of fastenings in some products.



* Since we also manufacture sizes other than those in the catalog upon request, please contact our company's sales office for details.



* Use the idler pin (W/ID adapter).
▶▶ P118 and P119 ▶▶ P114

