

SUS Idler Sprockets

● Order No. Example

SUSID 40C 15 D15

Type No. No. of Teeth

Sprocket No.

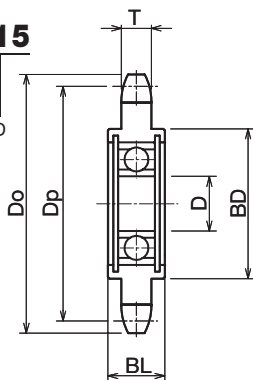

The KANA standard SUS (stainless steel) idler sprocket holds tension at the appropriate level during roller chain transmission. This product is made of stainless steel having excellent corrosion resistance and durability. The stainless steel bearing is located in the center of the sprocket.

 Stainless Steel  304

Type	No.	No. of Teeth	Inner Diameter D	Outer Diameter Do	Pitch Diameter Dp	Tooth Width T	Boss BD	Total Width BL	Used Bearing SUS	Weight kg	SUS Idler Pin Applicable Size	SUSID Adapter Applicable Size	¥
SUSID	35C	16	10 12	54	48.82	4.3	38	14	6000ZZ 6001ZZ	0.12 0.11	SUSIDP6000S SUSIDP6001S	SUSAD6000 SUSAD6001	
		18	15	60	54.85		44	17	6202ZZ	0.17	SUSIDP6202S	SUSAD6202	
		21	17	69	63.91		53	19	6203ZZ	0.25	SUSIDP6203S	SUSAD6203	
		25	20	81	76.00		60	21	6204ZZ	0.34	SUSIDP6204S	SUSAD6204	
	40C	13	10 12	59	53.07	7.2	38	14	6000ZZ 6001ZZ	0.16 0.15	SUSIDP6000S SUSIDP6001S	SUSAD6000 SUSAD6001	
		15	15	67	61.08		44	17	6202ZZ	0.20	SUSIDP6202S	SUSAD6202	
		17	17	76	69.12		53	19	6203ZZ	0.31	SUSIDP6203S	SUSAD6203	
		19	20	84	77.16		60	21	6204ZZ	0.41	SUSIDP6204S	SUSAD6204	
	50C	12	12	69	61.34	8.7	43	16	6201ZZ	0.22	SUSIDP6201S	SUSAD6201	
		13	15	74	66.34		44	17	6202ZZ	0.24	SUSIDP6202S	SUSAD6202	
		15	17	84	76.35		53	19	6203ZZ	0.38	SUSIDP6203S	SUSAD6203	
		17	20	94	86.39		60	21	6204ZZ	0.50	SUSIDP6204S	SUSAD6204	
	60C	11	12 15	76	67.62	11.7	44	16	6201ZZ	0.27	SUSIDP6201S	SUSAD6201	
		13	17	89	79.60		53	19	6203ZZ	0.47	SUSIDP6203S	SUSAD6203	
		14	20	95	85.61		60	21	6204ZZ	0.57	SUSIDP6204S	SUSAD6204	
		9	15	85	74.27		44	17	6202ZZ	0.39	SUSIDP6202S	SUSAD6202	
	80C	10	17	93	82.20	14.6	52	19	6203ZZ	0.58	SUSIDP6203S	SUSAD6203	
		11	20	102	90.16		60	21	6204ZZ	0.70	SUSIDP6204S	SUSAD6204	



Order Method

Sprocket No. and Quantity



Guide

* Since we also manufacture sizes other than those in the catalog upon request, please contact our company's sales office for details.



Postage

Same-day shipping



Use Examples

* Use the stainless steel idler pin/SUS ID adapter.
▶▶ P120 to P121 ▶▶ P115



Precautions

* The bearing is located in the center of the sprocket. With a view to improving quality even further, we are shifting over from the conventional one-spot snap ring fastening to a two-spot fastening as shown in the dimensional drawing. Because of this changeover, please note that there may be a mixture of fastenings in some products.

