

Roller Chains with Attachments K1 Type Attachments

● Order No. Example

40-2L K1 240 Links

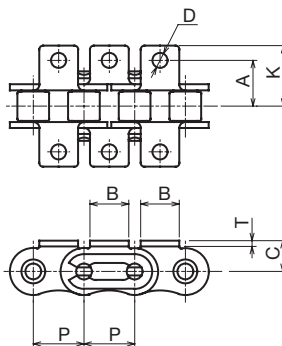
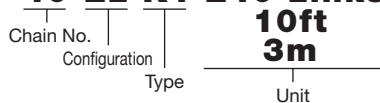

Chain No.	Attachment		Plate Thickness T	D	Attachment				Average Tensile Strength kN (kgf)	Maximum Allowable Tension kN (kgf)
	Configuration	Type			A	B	C	K		
40	ALL	K1	1.5	3.6	12.7	9.5	7.9	17.4	17.2 (1,750)	2.75 (280)
50	2L		2.0	5.2	15.9	12.7	10.3	22.3	27.9 (2,850)	4.41 (450)
60	3L		2.4	5.2	19.05	15.9	11.9	27.2	39.5 (4,000)	6.28 (640)
80	4L		3.2	6.8	25.4	19.1	15.9	35.2	68.6 (7,000)	10.69 (1,090)

Chain No.	Attachment		Approx. Weight kg/m	No. of Links	m	Unit					JL
	Attached per Location	Approx. Weight g				No. in Box (Quantity)	ALL ¥	2L ¥	3L ¥	4L ¥	
40	2.8	0.61	240L	3	8						
50	6.2	1.01	192L		5						
60	12.0	1.49	160L		4						
80	26.0	2.50	120L		3						



Order Method

Chain No. Configuration Type Unit and Quantity



Postage

Same-day shipping (Unit Only)

* Products with dimensional cutting are shipped in 3 working days.



Precautions

* There are no OL for chains with attachments.

* Dimensional cutting products will be charged as a combination of product price with chain cutting fee included.



Use Examples

For continued lubrication and effective anti-corrosion, protect your chains with Kanalon. See P344



Semi-F Series & FITLINK
Roller Chains
Chain Accessories
Idlers & Tensioners
Sprockets
Oilless Bushings
Transmission Accessories
Conveyor Chains/Sprockets
Chain Couplings
Resin Rails
Tight Speed/Center Tension Chains
Timing Belts/Pulleys/Hangers
Shaft Collars
Pinions/Racks/Miter Gears
Imperfect Products