

# Ultra Chain (Oilless type)

NL Type

● Order No. Example  
**40NL-240 Links**  
 Chain No. **10ft**  
**3m**  
 Unit

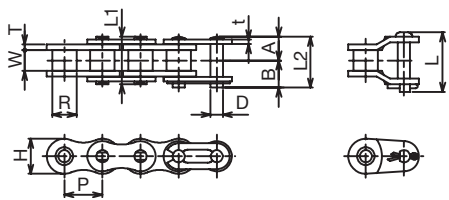

Chain No.	Pitch P	Roller Outer Diameter R	Inner Link Inner Width W	Link Plate				Pin					Average Tensile Strength kN (kgf)	Maximum Allowable Tension kN (kgf)
				Thickness		Width H	Diameter D	Length						
				T	t			A	B	L	L1	L2		
40NL	12.70	7.92	7.95	2.0	1.5	11.7	3.97	8.6	10.10	21.00	17.2	18.70	18.1 (1,850)	3.63 ( 370)
50NL	15.875	10.16	9.53	2.4	2.0	14.6	5.09	10.6	12.05	24.65	21.2	22.65	29.9 (3,050)	6.37 ( 650)
60NL	19.05	11.91	12.70	3.2	2.4	17.5	5.96	13.5	15.10	32.65	27.0	28.60	41.2 (4,200)	8.83 ( 900)
80NL	25.40	15.88	15.88	4.0	3.2	23.0	7.94	16.9	20.00	40.15	33.8	36.90	72.6 (7,400)	14.7 (1,500)

Chain No.	Approx. Weight kg/m	Unit				JL & OL		
		No. of Links	m	No. in Box (Quantity)	¥	¥		No. in Box (Quantity)
						JL	OL	
40NL	0.67	240L	3	10				100
50NL	1.08	192L		5				50
60NL	1.63	160L		5				25
80NL	2.76	120L		3				20

\* Operating Temperature: -10°C to 150°C

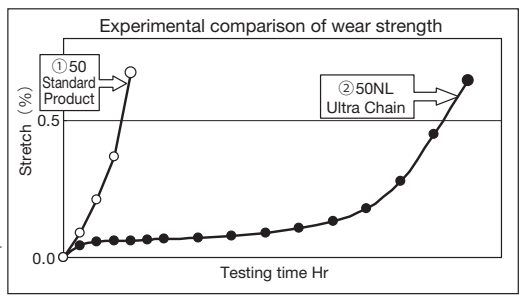
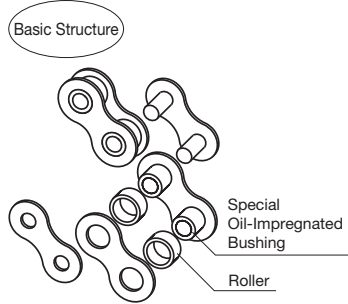

**Features** KANA Ultra (oilless type) Chains are maintenance-free chains using special oil-impregnated bushings for self-lubrication. Use them for places where lubrication is hard to implement or should be avoided. Black oxide finish is implemented on the plate to improve corrosion resistance. In addition, a nickel plating type is also available.





### Same-day shipping (Unit Only)

\* Products with dimensional cutting are shipped in 3 working days.



**Precautions**

- \* Because the inside plate is designed to be thick, pins are longer than those of standard chains.
- \* Although standard sprockets can be used for single row chains,
- \* Dedicated sprockets are required for multiple row ones. Coupler links of 80NL are cotter pin type.
- \* Dimensional cutting products will be charged as a combination of product price with chain cutting fee included.