

Dimensions (mm)

Straight RTS

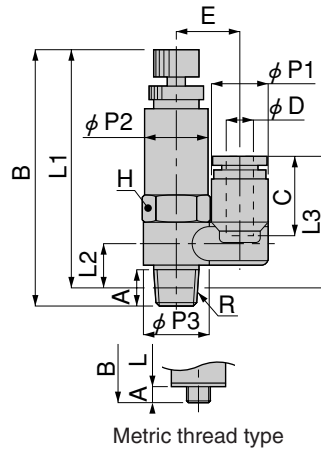

Model	Tube outer diameter ϕD	R	A	B		L1 ^{Note}		L2 ^{Note}	L3 ^{Note}	$\phi P1$	$\phi P2$	$\phi P3$	C	E	Width across flats H	Mass (g) [oz.]
				MAX	MIN	MAX	MIN									
RTS4-M5	4	M5X0.8	2.9	48.7	44.6	45.8	41.7	7.7	24.8	10.2	10	9.8	14.9	10.5	10	18 [0.63]
RTS4-01		R1/8	7.8	60	56	56	52	10.7	28.7		14	14.4		13	14	37 [1.31]
RTS6-M5	6	M5X0.8	2.9	48.7	44.6	45.8	41.7	7.7	26.9	12.6	10	9.8	17	12.2	10	18 [0.63]
RTS6-01		R1/8	7.8	60	56	56	52	10.7	30.8		14	14.4		14.2	14	38 [1.34]
RTS6-02		R1/4	11.3	64.8	60.8	58.8	54.8	12	32.1		17	18.4		17.2	17	60 [2.12]
RTS8-01	8	R1/8	7.8	60	56	56	52	10.7	32.2	14.6	14	14.4	18.1	15.2	14	39 [1.38]
RTS8-02		R1/4	11.3	64.8	60.8	58.8	54.8	12	33.6		17	18.4		18.2	17	62 [2.19]

Note: The L1, L2 and L3 dimensions for the taper thread type are the reference dimensions after the fittings are assembled.

Elbow RTL

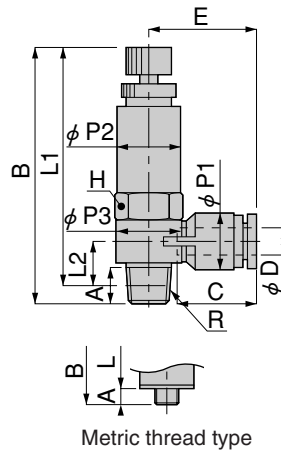

Model	Tube outer diameter ϕD	R	A	B		L1 ^{Note}		L2 ^{Note}	$\phi P1$	$\phi P2$	$\phi P3$	C	E	Width across flats H	Mass (g) [oz.]
				MAX	MIN	MAX	MIN								
RTL4-M5	4	M5X0.8	2.9	48.7	44.6	45.8	41.7	7.6	8	10	9.8	11	15.4	10	16 [0.56]
RTL4-01		R1/8	7.8	60	56	56	52	10.5	10	14	14.4	14.9	21.4	14	36 [1.27]
RTL6-M5	6	M5X0.8	2.9	48.7	44.6	45.8	41.7	8.4	10.5	10	9.8	11.6	17.5	10	16 [0.56]
RTL6-01		R1/8	7.8	60	56	56	52	10.7	12.4	14	14.4	17	23.5	14	36 [1.27]
RTL6-02		R1/4	11.3	64.8	60.8	58.8	54.8	12.2		17	18.4		25.5	17	59 [2.08]
RTL8-01	8	R1/8	7.8	60	56	56	52	11.7	14.4	14	14.4	18.1	26.9	14	38 [1.34]
RTL8-02		R1/4	11.3	64.8	60.8	58.8	54.8	13.2		17	18.4		28.4	17	60 [2.12]

Note: The L1 and L2 dimensions for the taper thread type are the reference dimensions after the fittings are assembled.