

# TA,FA

# TWO-ARM HANDWHEELS / FOUR-ARM HANDWHEELS



Original ELESA Model VBR.



**TA**  
(Two-Arm)

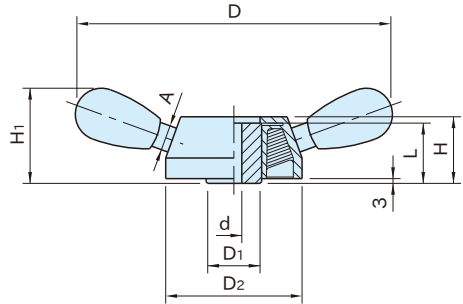

**TA**  
(Two-Arm)



**FA**  
(Four-Arm)

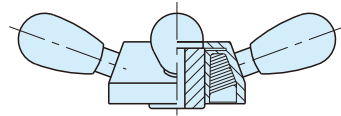

**FA**  
(Four-Arm)

Type	Body	Hub	Lever	Knob
<b>TA</b> 200	Glass-fiber reinforced polyamide	Steel(SUM22L)	Steel(SS400)	Polyamide plastic Black
<b>FA</b> 270	Glossy Finish Black	Black oxide finish	Hard chrome plated	Phenolic plastic Glossy Finish Black
<b>310</b>	Black		Silver satin	Glossy Finish Black

Two-Arm		Four-Arm		D	H <sub>1</sub>	D <sub>2</sub>	H	D <sub>1</sub>	d (H9)	L	A
Part Number	Weight(g)	Part Number	Weight(g)								
<b>TA200</b>	600	<b>FA200</b>	780	200	60	86	42	35	10	38	16
<b>TA270</b>	715	<b>FA270</b>	1,030	274	74						
<b>TA310</b>	780	<b>FA310</b>	1,150	312	80						

### Features:

- Comes with an **OG-M** handle.
- Screwed-in levers.

### Notes:

- Use in hot or highly humid circumstances can deteriorate the plastic material properties.
- Once **TA** 270, **TA** 310, **FA** 270 and **FA** 310 run out of stock, they will be provided with an **OG-M** handle instead of **OG** handle.

### Technical Information

Working temperature : Between -20°C and 110°C

### Strength Data

Max. Torque  $T_1 = 195 \text{ N}\cdot\text{m}$

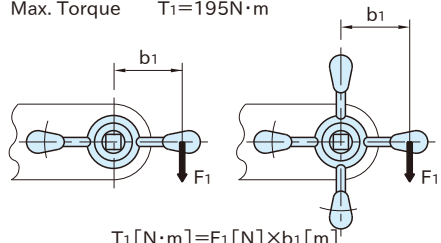

$$T_1 [\text{N}\cdot\text{m}] = F_1 [\text{N}] \times b_1 [\text{m}]$$