

STF-N,ST-N

ADJUSTABLE SAFETY CLAMP LEVERS

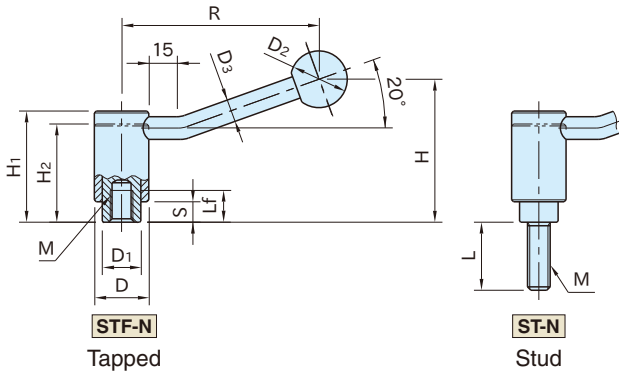

Type	Body / Lever	Locking Element	Knob
STF-N	Steel(SUM22L) Powder coating Black	Steel(SUM22L) Black oxide finish	Phenolic plastic Black
ST-N			Black



Size	Teeth	R	H	D	H ₁	H ₂	M	D ₁	D ₂	D ₃	S
STF-N 10	22	87	63	24	49	44	M10×1.5	16	25	10	9
STF-N 12	24	106	74	28	57	51	M12×1.75	19	32	12	11
ST-N 16	26	128	87	33	64	57	M16×2	23		13	12

How To Use



Turn the handle to a desired position.



Press down the handle to engage the teeth with the locking element.



When the handle is released, the return spring automatically disengages the teeth again.