

# PGL LEVER ARMS

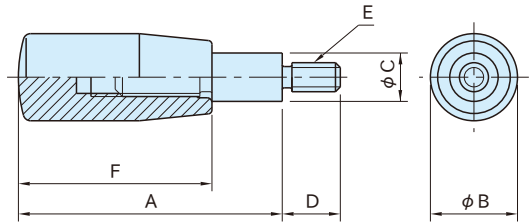

ELESA Original Design BL.366



Type	Knob	Arm
<b>PGL</b>	Phenolic plastic Glossy Finish Black	Steel (SS400) Hard chrome plated finish Satin finish Silver matte
<b>PGL-SUS</b>		Stainless steel (SUS303)

Steel	Stainless Steel	A	B	C	D	E	F	Weight (g)
Part Number	Part Number							
<b>PGL 6× 63</b>	<b>PGL 6× 63-SUS</b>	63	18	10	12	M 6×1	40	38
<b>PGL 6× 80</b>	<b>PGL 6× 80-SUS</b>	80						49
<b>PGL 6×100</b>	<b>PGL 6×100-SUS</b>	100						61
<b>PGL 8× 80</b>	<b>PGL 8× 80-SUS</b>	80	21		20	M 8×1.25	50	57
<b>PGL 8×100</b>	<b>PGL 8×100-SUS</b>	100						73
<b>PGL 8×125</b>	<b>PGL 8×125-SUS</b>	125						85
<b>PGL10×100</b>	<b>PGL10×100-SUS</b>	100	23	12	25	M10×1.5	65	82
<b>PGL10×125</b>	<b>PGL10×125-SUS</b>	125						112
<b>PGL10×160</b>	<b>PGL10×160-SUS</b>	160						154
<b>PGL12×125</b>	<b>PGL12×125-SUS</b>	125	26	14	30	M12×1.75	80	166
<b>PGL12×160</b>	<b>PGL12×160-SUS</b>	160						208
<b>PGL12×200</b>	<b>PGL12×200-SUS</b>	200						256

- The knob is pressed onto the arm and glued.
- Working temperature : Between -20°C and 110°C