

MCH METAL HINGES

ELESA Original Design CMZ.

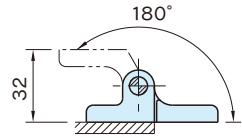
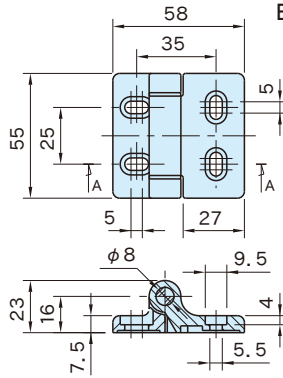

| Body | Pivot Pin | Spacer |
|----------------------|--------------------------|-------------------|
| Die-cast zinc (ZDC1) | Stainless steel (SUS304) | Polyamide plastic |
| Black Matte | | Black Matte |

| Part Number | Weight (g) |
|------------------|------------|
| MCH5855SL | 175 |

· Pivot Angle : Max. 180°

Application Example

