

HR / HRB

HOIST RINGS, Center-Pull Style

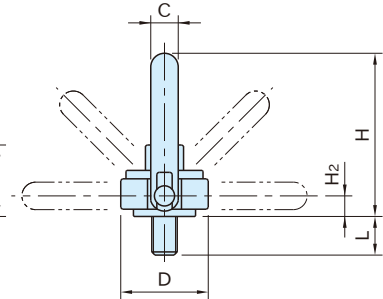
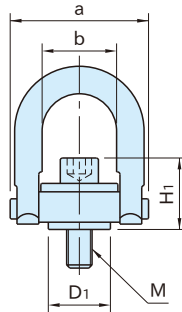

[HR Type]

Material : SCM440 steel

Finish : Black oxide

[HRB Type]

Material : SCM440 steel

Finish : Nickel-based coating

* HR42, HR48, HR64 and all HRBs are not stock items.

Strength Factor 5:1

Black oxide Part Number	Nickel-based coating Part Number	M	L	a	H	C	D	b	H ₁	H ₂	D ₁	Allowable Load(kN)	Weight (kg)
HR 6	HRB 6	M 6x1	12						24			2	0.15
HR 8	HRB 8	M 8x1.25	12.5	46.7	67.8	9.7	□25.4	21.8	26	8.7	19	4	0.17
HR10	HRB10	M10x1.5	17.5						28			4.5	
HR12	HRB12	M12x1.75	19		123				43.5			10.5	1.1
HR12L	-				170.7								1.3
HR16	HRB16	M16x2	29	89.4	123	19	57.3	44.7	47.5	15.7	38.1	19	1.1
HR16L	-				170.7					45.5			
-	HRB20S	M20x2.5	34		123				51.5			21.5	1.2
HR20	HRB20				163					64.5			
HR20L	-		32	130.6	206	25.4	82.7	71.1	79.5	19.4	58.7	30	3.3
HR24	HRB24	M24x3	37		163				68.5			42	3.1
-	HRB30S	M30x3.5	46		163				68.5			70	6.3
HR30	HRB30			165.1	221.7	31.7	104.5	88.9	82.5	25.3	81		6.4
HR36	HRB36	M36x4	68						106			110	15.5
HR42	HRB42	M42x4.5		217.2	316.7	44.4	133.7	114.3	112	33.3	106.4	125	16
HR48	HRB48	M48x5	88						118			135	16.8
HR64	HRB64	M64x6	96	297.6	419.1	57.15	185.7	152.4	152	48.5	146	225	40

Bolt replacement kits are available.

A certificate of proof test accompanies the product.

Technical Information

Heat resistance : Max. 204°C