

**CTR / CTRS CROWN PULLEYS**



**CTR**  
(Plastic)



**CTRS**  
(Steel)

Type	Body	Bearing	Retaining Ring
<b>CTR</b>	Glass-fiber reinforced polyamide plastic Black	Steel	-
<b>CTRS</b>	Steel (S45C) Electroless nickel plated finish		Steel

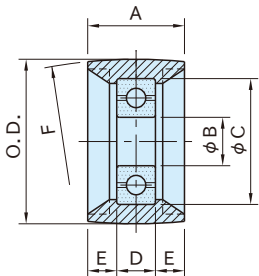

**CTR** 1535 to 2550  
(Plastic)

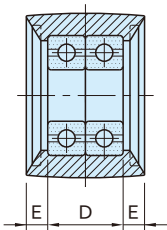

**CTRS** 3050 to 5560  
(Plastic)

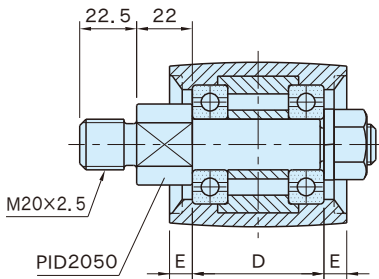

**CTR** 6065  
(Plastic)

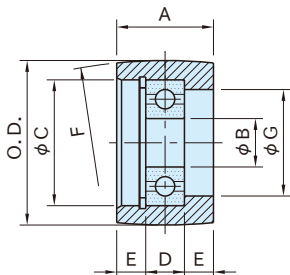

**CTRS** 1535 & 2045  
(Steel)

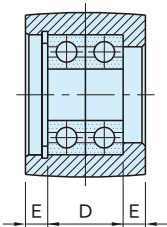

**CTRS** 3050 & 4550  
(Steel)