

CP123

OD HOLDING CLAMPS (Wedge Style/Round)

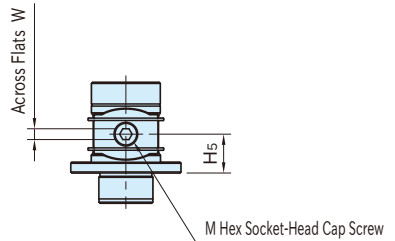

Body	Wedge
Steel(S45C) Black oxide finished	Steel(S45C) Black oxide finished Quenched & tempered

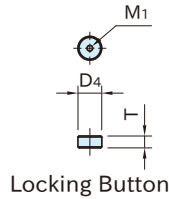
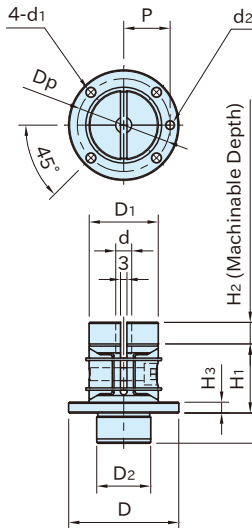

Part Number	D ₁	d	H	H ₂	D	H ₁	H ₃	D ₂ (g7)	H ₄	d ₁	D _p	d ₂	P
CP123-03201	32	7.4	42	10	51	32	5	25	14	4.5	43	5	21.5
CP123-05001	50	11.4	63	15	75	48	7	40	19	5.5	65	6	32.5

Part Number	M	W	H ₅	M ₁	D ₄	T	Clamping Force (N)	Allowable Screw Torque (N·m)	Weight (kg)
CP123-03201	M 6×1 -25L	5	18	M3×0.5	7	3.5	3,000	9	0.33
CP123-05001	M10×1.5-35L	8	27		11	5.5	7,000	42	1.2

Technical Information

- Locating Repeatability ±0.08

Furnished Parts

- 1 of locking button
- Spring pin
(φ 5×10L for CP123-03201)
(φ 6×14L for CP123-05001)

Notes:

- Do not tighten the clamping screw without the workpiece set to prevent damage and deformation.
- Do not machine the jaws beyond the machinable depth.