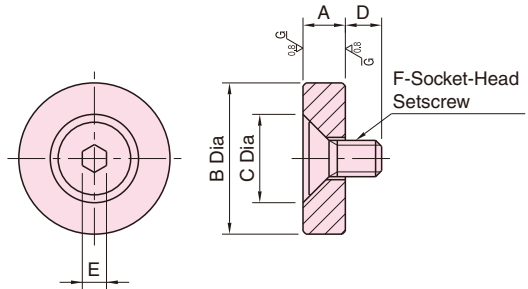

**BJ763****FLAT FEET**

[Body]

Material : S45C steel

Heat Treat : Quenched and tempered

Finish : Black oxide

Precision ground

Part Number	A ( $\begin{smallmatrix} +0.01 \\ 0 \end{smallmatrix}$ )	B	C	D	E	F	Weight (g)
<b>BJ763-06001</b>	5	25	14	7.7	4	M6x1	20
<b>BJ763-06002</b>		30					30
<b>BJ763-06003</b>		35					40
<b>BJ763-06004</b>	10	25	10.7	4	M6x1	40	
<b>BJ763-06005</b>		30				60	
<b>BJ763-06006</b>		35				80	
<b>BJ763-08001</b>	10	30	19.4	11.3	5	M8x1.25	60
<b>BJ763-08002</b>		35					80
<b>BJ763-08003</b>		40					100
<b>BJ763-08004</b>	15	30	11.3	5	M8x1.25	90	
<b>BJ763-08005</b>		35				115	
<b>BJ763-08006</b>		40				150	

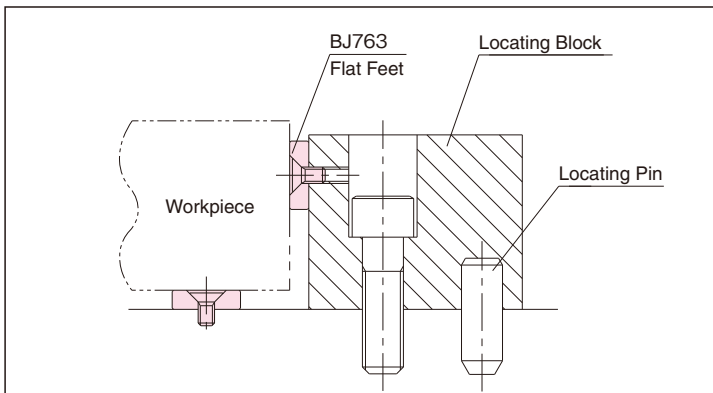
**How To Use**

Use to support and locate a workpiece. The accuracy of a locating block can be easily compensated by regrinding the top surface of Flat Feet.