

BJ760

SCREW REST PADS

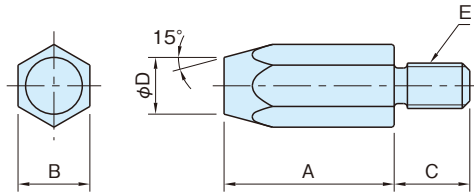

Material & Finish

Steel (S45C)
 Quenched and tempered
 Black oxide finish
 Heat treated to Rc33-39

| Part Number | A | B | C | D | E | Weight (g) |
|--------------------|----|----|----|----|----------|------------|
| BJ760-06001 | 10 | 10 | 11 | 8 | M 6×1 | 6 |
| BJ760-06002 | 20 | | | 6 | | 13 |
| BJ760-08001 | 15 | 13 | 13 | 10 | M 8×1.25 | 18 |
| BJ760-08002 | 30 | | | 9 | | 33 |
| BJ760-10001 | 20 | 17 | 16 | 13 | M10×1.5 | 44 |
| BJ760-10002 | 40 | | | | | 80 |
| BJ760-12001 | 25 | 19 | 20 | 15 | M12×1.75 | 70 |
| BJ760-12002 | 50 | | | | | 120 |