

**BJ734****CLAMP RESTS**

Body
Steel (S45C)
Quenched and tempered
Black oxide finish

Part Number	B	C	D	E	F	G	Weight (g)
BJ734-08011	20	8	7	17	M 8×1.25	18	28
BJ734-08001	30					28	32
BJ734-08002	40					38	35
BJ734-10011	22	10	8	19	M10×1.5	20	39
BJ734-10001	32					30	45
BJ734-10002	47					45	55
BJ734-12011	33	12	10	24	M12×1.75	30	63
BJ734-12001	43					40	72
BJ734-12002	58					55	85
BJ734-16011	33	16	10	30	M16×2	30	134
BJ734-16001	43					40	150
BJ734-16002	58					55	170
BJ734-20011	55	20	15	36	M20×2.5	45	260
BJ734-20001	75					65	310

### Application Example

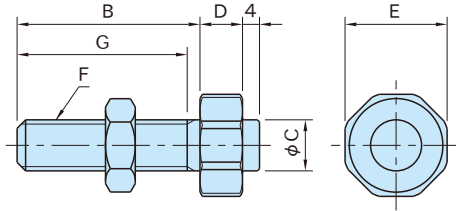