

# BJ700

# LOCATING SCREWS (Standard)

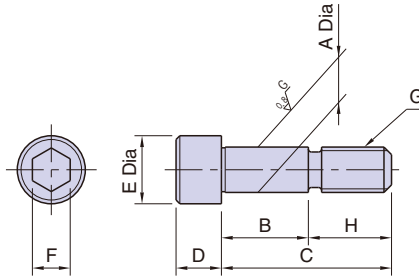

Material : SCM435 steel  
Heat Treat : Quenched and tempered  
Finish : Black oxide  
Precision ground

Part Number	A (f7)	B	C	D	E	F	G	H	Weight (g)
<b>BJ700-12045</b>	12	23	45	12	18	10	M12x1.75	22	52
<b>BJ700-12055</b>		33	55						59
<b>BJ700-12065</b>		43	65						68
<b>BJ700-12075</b>		53	75						76
<b>BJ700-16055</b>	16	30	55	16	24	14	M16x2	25	120
<b>BJ700-16065</b>		40	65						134
<b>BJ700-16075</b>		50	75						145

### How To Use

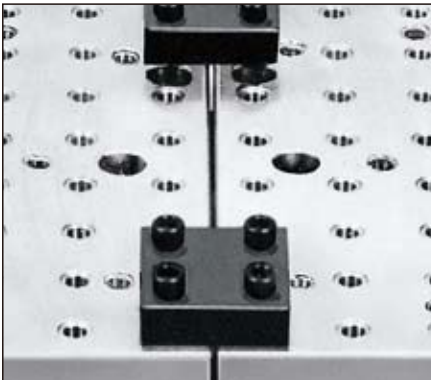

Use to locate a component with two or more locating-screw holes.