

ティー中ニップル
MALE BRANCH TEE

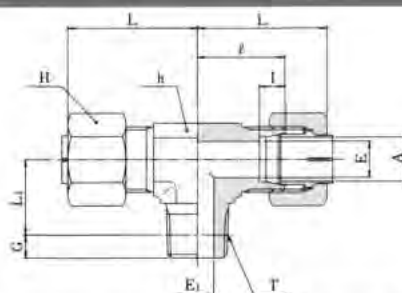

Unit : mm

継手の呼び Part No.	Tube OD A	(R) T	E	E ₁	Gauge Length G	二面幅 Flats h	六角対辺 Hex. H	I	ℓ	Approx. L (約)	Approx. L ₁ (約)	重量 (kg)
KTN06-010CE	6	1/8	4.5	4.5	3.97	12	12	5.5	17	26.3	14.5	0.036
KTN08-010CE	8	1/8	6	4.5	3.97	12	14	5.5	17.5	27.5	15	0.044
KTN08-020CE	8	1/4	6	7	6.01	14	14	5.5	17.5	27.5	18	0.052
KTN10-020CE	10	3/8	8	7	6.01	14	17	5.5	20	30	18	0.064
KTN10-030CE	10	3/8	8	9	6.35	17	17	5.5	21	31	19.7	0.086
KTN12-020CE	12	1/4	10	7	6.01	17	19	6	21	31	19	0.088
KTN12-030CE	12	3/8	10	9	6.35	17	19	6	21	31	19.7	0.089
KTN16-030CE	16	3/8	13	9	6.35	24	27	8	28	40.6	24.7	0.178
KTN16-040CE	16	1/2	13	12	8.16	24	27	8	28	40.6	25.8	0.239
KTN20-040CE	20	1/2	17	12	8.16	27	30	8	30.5	44.8	27.8	0.315
KTN20-060CE	20	3/4	17	16	9.53	30	30	8	30.5	44.8	28.5	0.357
KTN25-060CE	25	3/4	22	16	9.53	36	36	9	35.5	50.3	31.5	0.525
KTN25-080CE	25	1	22	22	10.39	36	36	9	35.5	50.6	33.6	0.540
KTN30-060CE	30	3/4	26	16	9.53	41	41	9	39.5	54.8	34.5	0.727
KTN30-080CE	30	1	26	22	10.39	41	41	9	39.5	54.8	36.6	0.712
KTN30-100CE	30	1 1/4	26	31	12.7	46	41	9	41	56.3	42.3	1.185

ティー片ニップル
MALE RUN TEE

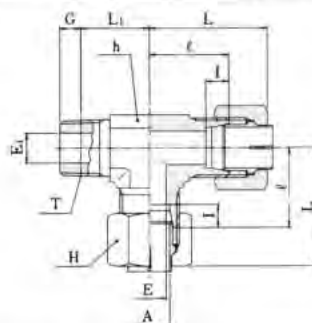

Unit : mm

継手の呼び Part No.	Tube OD A	(R) T	E	E ₁	Gauge Length G	二面幅 Flats h	六角対辺 Hex. H	I	ℓ	Approx. L (約)	Approx. L ₁ (約)	重量 (kg)
KTK06-010CE	6	1/8	4.5	4.5	3.97	14	12	5.5	18	27.3	15	0.050
KTK08-010CE	8	1/8	6	4.5	3.97	14	14	5.5	18	28.5	15	0.054
KTK08-020CE	8	1/4	6	7	6.01	17	14	5.5	20.5	30.5	18	0.075
KTK10-020CE	10	1/4	8	7	6.01	17	17	5.5	21	31	18	0.094
KTK10-030CE	10	3/8	8	9	6.35	19	17	5.5	21	31	19.7	0.109
KTK12-020CE	12	1/4	10	7	6.01	17	19	6	22	32	19	0.092
KTK12-030CE	12	3/8	10	9	6.35	19	19	6	22	32	19.7	0.104
KTK16-030CE	16	3/8	13	9	6.35	24	27	8	28	40.6	24.7	0.219
KTK16-040CE	16	1/2	13	12	8.16	24	27	8	28	40.6	25.8	0.245
KTK20-040CE	20	1/2	17	12	8.16	27	30	8	30.5	44.8	27.8	0.308
KTK20-060CE	20	3/4	17	16	9.53	30	30	8	30.5	44.8	28.5	0.355
KTK25-060CE	25	3/4	22	16	9.53	36	36	9	35.5	50.3	31.5	0.516
KTK25-080CE	25	1	22	22	10.39	36	36	9	35.5	50.3	33.6	0.540
KTK30-060CE	30	3/4	26	16	9.53	41	41	9	39.5	54.8	34.5	0.759
KTK30-080CE	30	1	26	22	10.39	41	41	9	39.5	54.8	36.6	0.801
KTK30-100CE	30	1 1/4	26	31	12.7	46	41	9	41	56.3	42.3	0.951