

## No.139 ボス

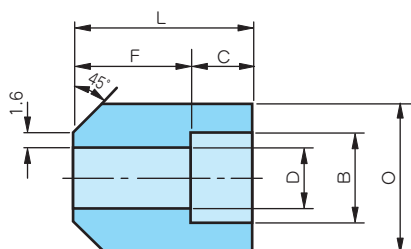

## Sch-80

単位：mm

呼び方	B	D	F	C	L	O
SWBOSS-8A-S80	14.3	9.4	15.9	10	25.9	22
SWBOSS-10A-S80	17.8	12.7	17.5	10	27.5	26
SWBOSS-15A-S80	22.2	16.1	22.2	10	32.2	32
SWBOSS-20A-S80	27.7	21.4	23.8	13	36.8	38
SWBOSS-25A-S80	34.5	27.2	28.6	13	41.6	46
SWBOSS-32A-S80	43.2	35.5	30.2	13	43.2	55
SWBOSS-40A-S80	49.1	41.2	31.8	13	44.8	63
SWBOSS-50A-S80	61.1	52.7	41.3	16	57.3	78
SWBOSS-65A-S80	77.1	65.9	42.9	16	58.9	95
SWBOSS-80A-S80	90.0	78.1	44.5	16	60.5	110

## Sch-160

単位：mm

呼び方	B	D	F	C	L	O
SWBOSS-15A-S160	22.2	12.3	22.2	10	32.2	38
SWBOSS-20A-S160	27.7	16.2	23.8	13	36.8	42
SWBOSS-25A-S160	34.5	21.2	28.6	13	41.6	50
SWBOSS-32A-S160	43.2	29.9	30.2	13	43.2	60
SWBOSS-40A-S160	49.1	34.4	31.8	13	44.8	70
SWBOSS-50A-S160	61.1	43.1	41.3	16	57.3	85
SWBOSS-65A-S160	77.1	57.3	42.9	16	58.9	100
SWBOSS-80A-S160	90.0	66.9	44.5	16	60.5	120

## No.124 キャップ

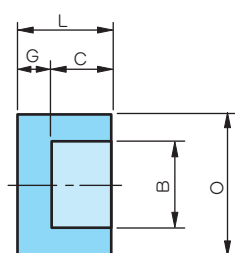

## Sch-80

単位：mm

呼び方	B	G	C	L	O
SWCA-8A-S80	14.3	6	10	16	22
SWCA-10A-S80	17.8	7	10	17	26
SWCA-15A-S80	22.2	8	10	18	32
SWCA-20A-S80	27.7	8	13	21	38
SWCA-25A-S80	34.5	11	13	24	46
SWCA-32A-S80	43.2	11	13	24	55
SWCA-40A-S80	49.1	13	13	26	63
SWCA-50A-S80	61.1	14	16	30	78
SWCA-65A-S80	77.1	17	16	33	95
SWCA-80A-S80	90.0	19	16	35	110

## Sch-160

単位：mm

呼び方	B	G	C	L	O
SWCA-15A-S160	22.2	9.2	10	19.2	38
SWCA-20A-S160	27.7	10.4	13	23.4	42
SWCA-25A-S160	34.5	12.6	13	25.6	50
SWCA-32A-S160	43.2	14.6	13	27.6	60
SWCA-40A-S160	49.1	15.9	13	28.9	70
SWCA-50A-S160	61.1	18.5	16	34.5	85
SWCA-65A-S160	77.1	23.4	16	39.4	100
SWCA-80A-S160	90.0	26.4	16	42.4	120