

# HO/HO小径 北川油圧・エアチャック用

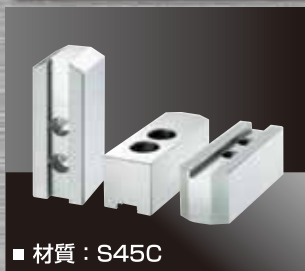

■ 材質：S45C

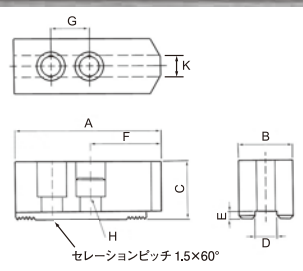

爪形状

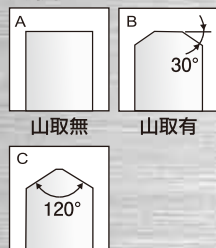

小径

取付ボルト穴寸法

インチ	穴径(mm)
4	HO4-H23:13.5
	HO4-H40:11
5	HO5-H27:13.5
	その他:14
6	17
8	19
10	19
12	23
15	32

単位：mm

生爪型式		希望小売価格 (1set3個入/円税別)	A	B	C	D	E	F	G	H	K	爪形状	
HO	4	H23	3,000	51	23	23	8	4	26	15	M6	3	C
		H40	7,300	48	19	40		3	25			6	B
	5	H27	3,100	57	23	27	10	3	29	18	M8	12	B
		H31	5,100			31							
		H40	7,600			40							
		H60	10,700			60							
	6	H30	3,300	73	31	30	12	5	38	20	M10	13	B
		H36	3,600			36							
		H50	5,200			50							
		H60	5,600			60							
	6N	H30	3,300	73	31	30	12	5	38	20	M10	-	A
		H36	3,600			36							
		H50	5,200			50							
		H60	5,600			60							
	6S (小径)	H36	4,500	73	31	36	12	5	43	20	M10	3	C
		H50	5,700			50							
		H60	6,000			60							
		H80	7,000			80							
	8	H37	3,600	95	35	37	14	5	46	25	M12	15	B
		H42	4,000			42							
H50		5,800	50										
H60		6,200	60										
H70		7,000	70										
H80		7,600	80										
H90		9,100	90										
H100		10,100	100										
8N	H37	3,600	95	35	37	14	5	46	25	M12	-	A	
	H42	4,000			42								
	H50	5,800			50								
	H60	6,200			60								
	H70	7,000			70								
	H80	7,600			80								
	H90	9,100			90								
	H100	10,100			100								
8S (小径)	H37	4,600	95	35	37	14	5	54	25	M12	3	C	
	H42	4,700			42								
	H50	6,300			50								
	H60	7,000			60								
	H80	7,500			80								
10	H42	4,800	110	40	42	16	5	50	30	M12	17	B	
	H50	6,300			50								
	H60	7,700			60								
	H70	8,500			70								
	H80	10,800			80								
	H90	11,300			90								
	H100	13,300			100								
10N	H42	4,800	110	40	42	16	5	50	30	M12	-	A	
	H50	6,300			50								
	H60	7,700			60								
	H70	8,500			70								
	H80	10,800			80								
	H90	11,300			90								
10S (小径)	H42	6,400	110	40	42	16	5	60	30	M12	4	C	
	H60	9,000			60								
	H80	10,500			80								

生爪